

ACCELERATE

2025



BOLD MOVE

BAPTIST RESOURCE NETWORK OF PENNSYLVANIA/SOUTH JERSEY
ANNUAL GATHERING & BUSINESS SESSION | OCTOBER 7, 2025



The **SIMPLE** Solution for **MINISTRY FUNDS**

MAKES COMPLEX INVESTMENT DECISIONS SIMPLE AND PROVIDES MINISTRIES THE FREEDOM TO FOCUS ON WHAT MATTERS MOST.

WHAT IS THE MINISTRY FUND?†

The Ministry Fund is a professionally managed and morally screened investment fund designed specifically for long-term ministry dollars. It is strategically structured to provide reliable income for ministry, grow the investment to offset inflation, and remain true to Christian principles.



INSTITUTIONAL QUALITY

Seeking the best management options, The Ministry Fund offers access to institutional fund managers and asset classes.



CHRISTIAN PERSPECTIVE

Holding to Christian values, The Ministry Fund seeks to avoid investing in companies that profit from activities counter to God's Word.



LONG-TERM RECORD

Investing for over 35 years, The Ministry Fund has provided consistent investment management over multiple market cycles.



RELIABLE INCOME

Knowing the importance of consistent funding, The Ministry Fund is designed to provide reliable income on a quarterly basis.

OPEN A NEW ACCOUNT TODAY!

 Go to www.ministrytrustfinancial.org

 Email us at: contactus@ministrytrustfinancial.org

 Call us at: **470.851.2366**



† The Ministry Fund is a product of Ministry Trust, LLC

ACCELERATE

**55th Annual Meeting of the
Baptist Resource Network of PA/SJ**

SHERATON HARRISBURG-HERSHEY HOTEL

4650 Lindle Road, Harrisburg, PA 17111

“Have I not commanded you? Be strong and courageous. Do not be frightened, and do not be dismayed, for the Lord your God is with you wherever you go” (Joshua 1:9).



**Baptist Resource Network
Pennsylvania/South Jersey**

 **ACCELERATING KINGDOM MOVEMENT**

Hello, BRN Family!

WELCOME to our 5th annual Accelerate Conference. This year's Accelerate Conference theme is "Bold Move." I believe there has never been a better time to be bold... bold in our prayer, bold in our witness, and bold in our belief that God will do great things!

Joshua 1:9 says, "Have I not commanded you? Be strong and courageous. Do not be frightened, and do not be dismayed, for the Lord your God is with you wherever you go."

We are trusting God for even greater things through the Baptist Resource Network and our family of churches. At this year's conference, Dr. Jeff Iorg, president and CEO of the SBC Executive Committee, Dr. Tom Dawson, pastor of SOAR Church in Woodbine, N.J., and I will seek to boldly proclaim God's energizing power in our keynote presentations.

We also will host six breakout sessions from bold speakers who will challenge BRN churches and pastors to take bold moves in every aspect of ministry.

It is my desire that BRN churches all over our network will dream and act boldly, take hold of all that God has for them, and inspire others to have courage and rise up to do more than ever for God's Kingdom.

Missionary to PA/SJ,



DR. BARRY WHITWORTH

*Executive Director,
Baptist Resource Network*

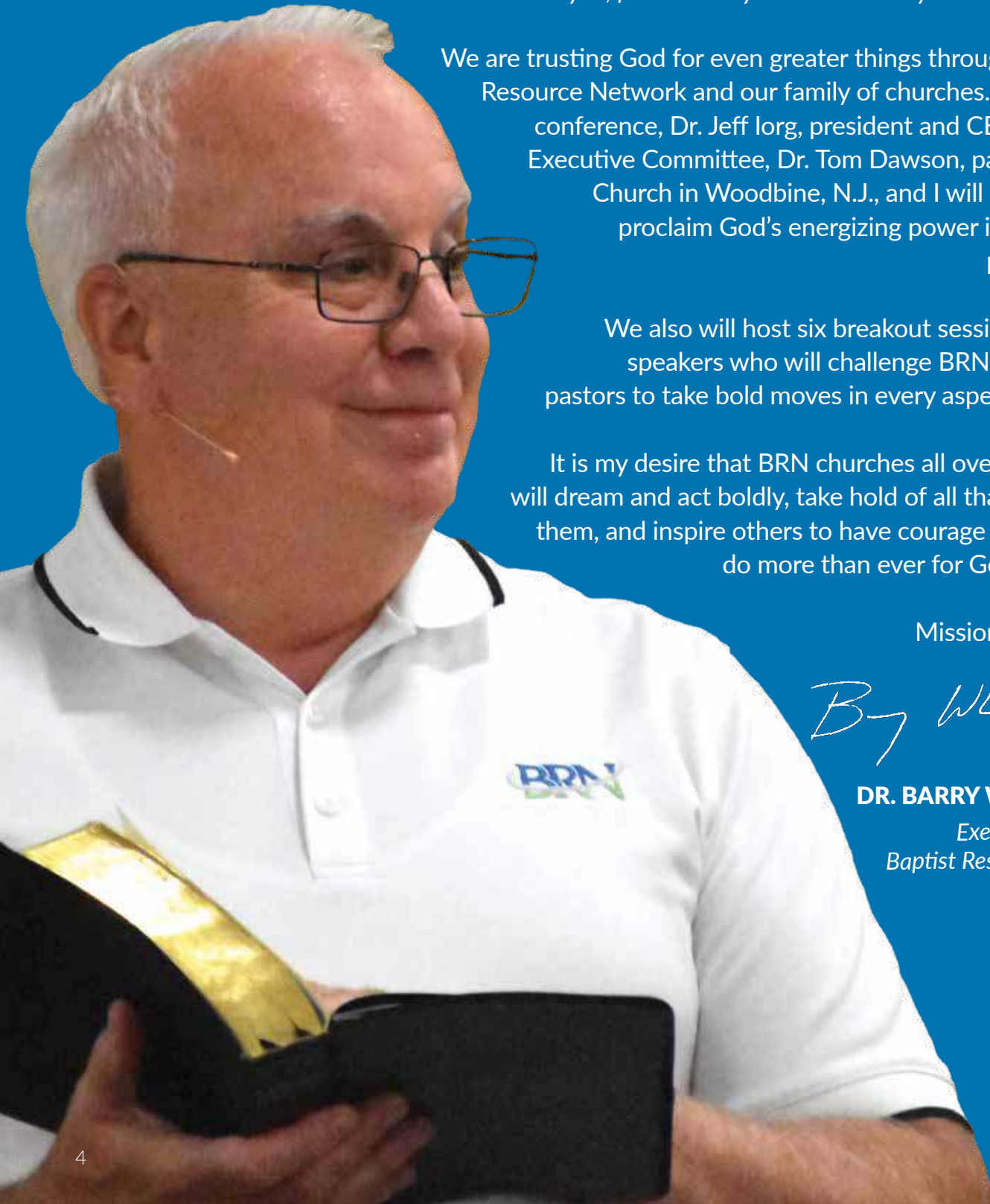

TABLE OF CONTENTS

| | |
|-----------------------------------------------|----|
| Welcome | 4 |
| Conference Schedule | 6 |
| Facilities Maps | 7 |
| Program Participants | 10 |
| Keynote Speakers | 12 |
| Musical Guests | 15 |
| Emcee | 16 |
| Breakout Sessions | 19 |
| Accelerate Sponsor..... | 33 |
| Accelerate Vendors | 34 |
| Centennial Cooperative Program Challenge..... | 36 |
| Mission Strategy..... | 40 |
| Your BRN Team | 43 |
| Ministry Reports..... | 46 |
| Baptist Resource Network Glossary..... | 86 |
| Upcoming Dates..... | 87 |
| Session Notes | 90 |

ACCELERATE

is a publication of the Baptist Resource Network of Pennsylvania/South Jersey and BRN United.

4620 Fritchey Street
Harrisburg, PA 17109
(717) 652-5856
brnuned.org
helpdesk@brnuned.org

BARRY WHITWORTH
Executive Director

SHANNON BAKER
Editor/Director of Communications

ELIZABETH BENGE
*Executive Assistant
to Dr. Barry Whitworth*

MACALA MAYS
*Communications Associate;
Associate Editor*

ANDY WEBER
Director of Finance and Operations

BRN United is a member of the Association of State Baptist Publications, the Baptist Communicators Association, and the Evangelical Press Association.

ACCELERATE CONFERENCE SCHEDULE



| | |
|------------|----------------------------------------------|
| 8:30 a.m. | Business Session |
| 9:30 | Break/Prayer |
| 9:45 | Worship Session 1: Haney Love |
| 10:00 | Welcome |
| 10:15 | Main Session 1: Keynote: Dr. Barry Whitworth |
| 11:00 | Worship Session 2: Haney Love |
| 11:10 | Main Session 2: Keynote: Dr. Jeff Iorg |
| 11:55 | Explanation of Lunch, Networking, Expo |
| 12:00 p.m. | Lunch, Networking, Expo |
| 1:30 | Breakouts/Workshops |
| 2:45 | Break |
| 3:00 | Worship Session 3: Haney Love |
| 3:05 | Main Session 3: Keynote: Dr. Tom Dawson |
| 3:45 | Worship Session 4: Haney Love |
| 3:50 | Giveaways & Closing |
| 4:05 | Worship Session 4 (Reprise): Haney Love |

GETTING AROUND

THE SHERATON HARRISBURG HERSHEY HOTEL

MAIN SESSION LEVEL

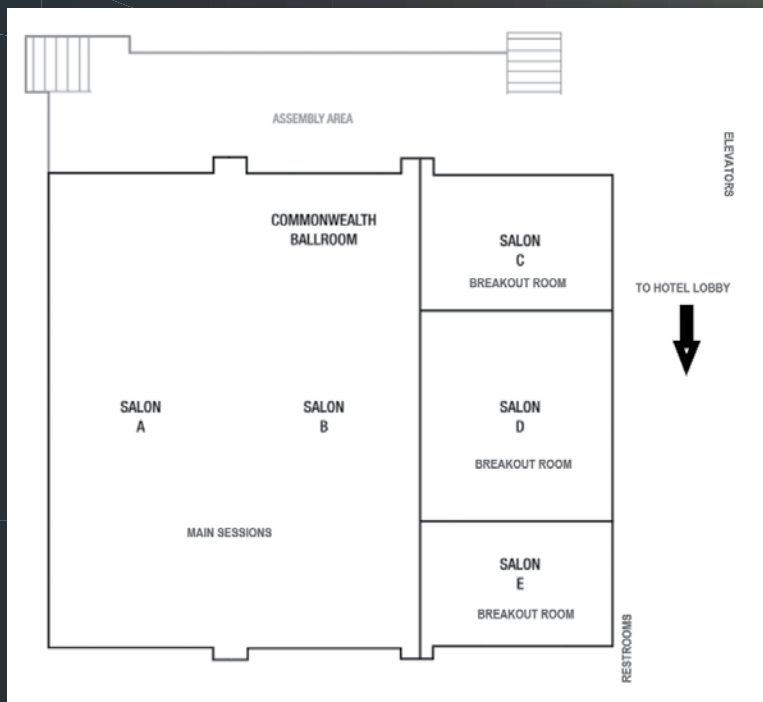

LOWER LEVEL

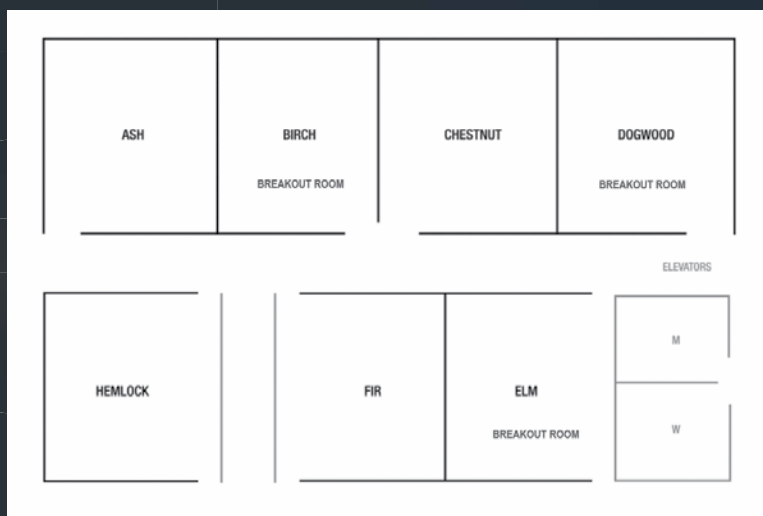

SHERATON HARRISBURG HERSHEY HOTEL

4650 Lindle Road, Harrisburg, PA 17111

REGISTRATION

Registration is located in the Lobby near the Front Desk. You must stop by registration, even if you pre-registered online, so that we can provide you with a meeting information packet and a name badge.

COFFEE

Coffee is located at the back of the Main Session room from 8:30-10:30 a.m. and again in the afternoon from 2:30-4 p.m.

MEALS

A continental breakfast will be served during the Business Session in Salons A & B. Boxed lunches will be available in the main hallway.

EXPO

Displays are located in the Convention Center Lobby as well as in the main hallway going towards the hotel entrance.

SPONSOR & VENDOR BINGO*

To be entered to win a gift basket, please visit at least ten (10) of our sponsors & vendors and have them mark their logo on the provided form.

Fill out this form and place the whole bingo flyer in the container of the gift you would like to win.

All entries must be received by the start of the 3:00 p.m. main session. Drawings will take place in the main session room after 4:00 p.m.

GIVEAWAYS

*You must be present in order to receive a giveaway. No purchase is necessary. Thank you to our sponsor and vendors, who made this possible.

NOTE

Schedule and participants are subject to change.



- *Have I not commanded you? **Be strong and courageous.** Do not be frightened, and*

LORD

*do not be dismayed, for the **Lord your God** is with you wherever you go.*

AT A GLANCE

LIST OF PARTICIPANTS

Larry Anderson BRN Director of Church Advancement & Evangelism; Pastor, Great Commission Church, Phila.
Elizabeth Benge..... BRN Executive Assistant to Barry Whitworth
Tim Boger..... Pastor, Big Woods Bible Church, Lock Haven; Trustee for the SBC Executive Committee
Kyle Canty..... Send City Missionary for Philadelphia, North American Mission Board
Brennan Coughlin BRN Board Member and Senior Pastor, Fellowship CrossPoint Church, Chesterfield, N.J.
Tom DawsonSenior Pastor, SOAR Church, Woodbine, N.J.
Ryan Day..... BRN Executive Board Member; Lead Pastor, Wrightsdale Baptist Church, Peach Bottom, Pa.
Greg Drayer..... BRN Church Advancement Consultant, West Region; Pastor, Rolling Hills Church, Verona, Pa.
Eric and Anissa Haney.....Haney Love, Philadelphia, Pa.
Kenton Hunt..... BRN Director of Disaster Relief
Jason Hunter.....BRN Executive Board President and Senior Pastor, First Baptist Church of Clarion, Pa.
Jeff Iorg..... President/CEO, Southern Baptist Convention Executive Committee
Mary Landis..... BRN Women's Ministry Consultant
Kelly Love.....National Director of Sales, Trail Life
David Ludwig BRN Director of Discipleship & Leadership Development
Kevin MarsicoChief of Global Ministry, DCPI; and Lead Pastor, Northstar Church in Frederick, Md.
Buff McNickle BRN Director of Compassion Ministry & Partnership Development
Jennifer Musser BRN Executive Board Recording Secretary
John Opalewski Founder & CEO, Converge Coaching, LLC
Rob Sheldon BRN Church Advancement Consultant, South Central Region; BRN Executive Board Member;
Pastor, Greencastle Baptist Church
Sarah Sheldon Pastor's Wife, Greencastle Baptist Church
Tim Walker..... Lead Pastor, Restored Church, Wilkes-Barre, Pa.
Andy Weber BRN Director of Finance and Operations
Barry Whitworth BRN Executive Director/Treasurer
Attorney R. Davis Younts Baptist Resource Network Legal Counsel, Younts Law

Our Mission...
to help churches
accelerate
Kingdom
MOVEMENT



Accelerate Conference Keynote Speakers



DR. JEFF IORG

President and CEO of the SBC Executive Committee

DR. JEFF IORG serves as the President of the Executive Committee of the Southern Baptist Convention. In that role, he facilitates the work of the SBC and its entities. One of his most important roles is managing the distribution of more than \$190 million in Cooperative Program funds given by churches to support global ministry and mission initiatives.

Prior to his current role, Dr. Iorg served as president of Gateway Seminary for 20 years and as Executive Director of the Northwest Baptist Convention for 10 years. Before that, he was a pastor and church planter.

Dr. Iorg is married to Ann, has three adult children, and five grandchildren.

Accelerate Conference

Keynote Speakers

DR. BARRY WHITWORTH

***Executive Director, Baptist
Resource Network of
Pennsylvania/South Jersey***

DR. BARRY WHITWORTH has been in ministry for over 30 years, serving as a mission pastor, associate pastor, church planter, pastor, interim pastor, transitional pastor and planter, church planting strategist, lead church planting catalyst, church planting director, and now executive director. Before his calling as Executive Director of the *Baptist Resource Network (BRN)* in February 2017, he was a church planting missionary and served as the *Multipling Churches Team Leader* for the BRN. Barry, who has planted churches and served on church staffs in Pennsylvania, New York, and Maryland, says his passion is the local church – to assist and encourage the churches in “reaching the lost [and] discipling the saved.” He seeks to help Pennsylvania/South Jersey Baptists “decrease lostness,” “push back darkness,” and “have an impact in our generation for such a time as this.” He and his wife Beth have two daughters and seven grandchildren.



Accelerate Conference Keynote Speakers

DR. TOM DAWSON

*Senior Pastor, SOAR Church,
Woodbine, New Jersey*

DR. THOMAS DAWSON JR. has served as the senior pastor of the SOAR Church since 1998. For the prior 13 years, Dr. Dawson held a data control analyst title at the Philadelphia Stock Market and various management titles in the Automatic Data Processing Brokerage Division, providing client support to major brokerage firms such as Merrill Lynch, Smith Barney, and Prudential. He successfully managed an entire department with a \$1.5 million budget. Under the leadership of Dr. Dawson, the SOAR Church has become multicultural and has grown from a membership of 50 to over 500 and serves residents in three counties. His vision has enabled the SOAR Church to impact its community, assisting in Autism Awareness, providing coats, school supplies and food, sponsored school trips for local schools and provided financial support to families in need.

Dr. Dawson is a current member of the FBI Citizens Organization, Coalition for a Safe Community, Cape May Regional Health Alliance, Cape May County Mental Health Alcohol & Drug Abuse Board, Cape May County Healthy Community Coalition, and Atlantic/Cape May Vicinage Diversity Inclusion, and Community Engagement Committee. Dr. Dawson has received numerous awards and honors for his industry, leadership, support of philanthropic activities, and community service. His greatest value is spending time strengthening his bond with the Lord, his family, and his community.



Accelerate Conference Musical Guests



Haney Love

North American Mission Board 'Musicianaries'

NAMB “musicianaries,” Eric and Anissa Haney formerly served as IMB missionaries in Stockholm, Sweden. God brought the Haney family together through music 18 years ago. They have been creating music together ever since, and their most recent band/album is called, HANEY LOVE. They desire to inspire hope, bring healing, and most of all, share the love of Jesus through their music. Anissa was born in the greater Philadelphia region in Pennsylvania. Eric, who is originally from Asheville, North Carolina, worked as a worship and student pastor for many years before moving overseas with his family. www.haneylove.com

NOTE: The Baptist Resource Network will record all of the Keynote and Breakout Sessions so you won't miss any of this great content! The videos will be made available via our weekly e-newsletter, *BRN United*. Not subscribed? That's easy! Just go to www.brnuned.org/news and click the Subscribe button. Your entire church can sign up today!

Accelerate Conference Emcee



Dr. Ryan Day

**Lead Pastor, Wrightsdale Baptist Church,
Peach Bottom, Pa.; BRN Board Member**

DR. RYAN DAY, a native of Westminster, Maryland, came to Wrightsdale Baptist Church as Lead Pastor in 2020. Prior to Wrightsdale, he served at Grace Baptist Church in Hazleton, Pennsylvania, for twenty years. Ryan is a 1998 graduate of Baptist Bible College (now Clarks Summit University) and 2005 graduate of Baptist Bible Seminary. He also holds a doctor of ministry degree from Baptist Bible Seminary.

When he's not ministering at the church, enjoying time with his family, or making plans for the next trip to Ocean City, Maryland, Ryan enjoys presidential biographies, the Baltimore Ravens, and playing guitar in praise and worship settings. He loves Lancaster County and is excited about "Accelerating Kingdom Movement" within the BRN. Ryan is married to Heather, and they have five sons and one daughter.

IS YOUR CHRISTIAN LIFE FEELING FLAT?

Then it's time to fly by faith.

GET YOUR
COPY TODAY!
Visit our table
at Accelerate



available now at 
and books.by/ryanday





NEXT
(one year)

NOW
(90 days)

FUTURE
(5 years)

LATER
(3 years)

At the Baptist Resource Network and Send Network PA/SJ, we seek to help churches accelerate Kingdom movement. To do that, we are committed to helping your church take your next step in ministry, whatever that step may be, and, ultimately, to help you achieve your next level in ministry.

What is the “Next Level” that God is calling you and your church to achieve?

It’s been said that most people overestimate what they can do in one year and underestimate what they can do in ten years. Although ten-year planning may seem too distant, what is God calling you and your church to accomplish in the next 3-5 years, or even this next year?

Let’s have a conversation to get you started!



**THE NEXT
LEVEL**



Next Level Journey: Charting Your Bold Moves

*What is your next **BOLD MOVE**?*

This guided journey is designed to help church leaders reflect deeply, plan intentionally, and move courageously, step by step, toward their next level of fruitful ministry.

Using the metaphor of a journey, this experience breaks down church and personal growth into five practical stages—each designed to provide clarity, direction, and momentum.

These stages aren't just checklists—they are an intentional itinerary for transformational progress within your church.

Whether you're leading a team, launching a project, or navigating personal growth, this framework will help you align vision with action—and take your next bold move with confidence.

Schedule your consultation today at brnunited.org/journey.

Your Next Step Starts Here.

2025 Accelerate Conference Breakout/Workshop Sessions

THE BAPTIST RESOURCE NETWORK OF PA/SJ seeks to help churches accelerate Kingdom movement. In other words, let's cooperate in a sustained effort of making disciples and establishing churches at an exponential rate to disrupt the kingdom of darkness in Pennsylvania/South Jersey! This year's line up of breakout sessions (and workshops, which involve real time planning) are designed for this purpose. Note their locations below.

MAIN SESSION (LOBBY) LEVEL:

- **SALON C:** *Forward with Courage: The Next Level* (Breakout)
- **SALON D:** *Frontline Faith: Preparing for Sudden Community Impact* (Workshop)
- **SALON E:** *Journey From Vision to Action: Building a Missional Strategy* (Workshop)

LOWER LEVEL:

- **DOGWOOD:** *From Stuck to Strong: Tackling the Barriers that Hold Us Back* (Breakout)
- **BIRCH:** *Flooding Every Corner: Spreading the Gospel Citywide* (Breakout)
- **ELM:** *Future Impact: Mobilizing My Church for Multiplication* (Breakout)

A photograph of Dr. Barry Whitworth, an older man with white hair and glasses, wearing a white collared shirt. He is smiling and holding a black microphone in his right hand, appearing to be speaking at an event. The background is a solid blue color.

Forward with Courage:

The Next Level

Every church leader reaches a crossroads—where the call is clear, but the next steps feel uncertain. Whether you're stepping into a new season, recalibrating your mission, or pursuing

PRESENTER: Dr. Barry Whitworth

BRN EXECUTIVE DIRECTOR

DR. BARRY WHITWORTH has been in ministry for over 30 years, serving as a mission pastor, associate pastor, church planter, pastor, interim pastor, transitional pastor and planter, church planting strategist, lead church planting catalyst, church planting director, and now executive director. Before his calling as Executive Director of the Baptist Resource Network in February 2017, he was a church planting missionary and served as the Multiplying Churches Team Leader for the BRN. He and his wife Beth have two daughters and seven grandchildren.

fresh vision, this breakout will help you move forward with courage using a simple but powerful planning tool: the Next Level Journey, which paves the way for greater success.

Designed for pastors and ministry leaders who are ready to move from where you are to where God is leading, this session will guide you through:

- **1 Big Goal:** Naming the God-sized outcome you're moving toward
- **4 Key Strategies:** Identifying the critical paths that will drive progress
- **1 Bold Move:** Defining what success looks like in this season
- **4 Bold Action Steps:** Determining your next right steps, starting now

You'll walk away with a clear, customized roadmap to lead your church or ministry to its next level—spiritually grounded, strategically focused, and practically achievable.



PRESENTER: Dr. Larry Anderson

BRN DIRECTOR OF CHURCH ADVANCEMENT AND EVANGELISM

DR. LARRY ANDERSON, BRN director of church advancement and evangelism, graduated from Philadelphia Biblical University (Cairn Univ.) with a bachelor of science degree in Bible with an emphasis in Christian leadership, and from Biblical Theological Seminary (Missio Seminary) with a master of divinity and a doctor in ministry degree. Dr. Anderson became the senior pastor of Great Commission Church in September 2004 and joined the staff of the Baptist Resource Network in April 2013. He is the co-author of the books, "Ask Me Why I'm Not In Church" (2019), "The Pastors' Diaries" (2022), and "The Pastors' Wives' Diaries: A Visible Journal of The Invisible Journey" (2024) and the founder and host of "Athens Avenue the Podcast" (2023).

Frontline Faith:

Preparing for Sudden Community Impact

When crisis hits—whether through natural disaster, tragedy, or unexpected disruption—churches are often among the first to respond. But effective response requires more than good intentions. It

PRESENTER: Kenton Hunt

BRN DIRECTOR OF DISASTER RELIEF

KENTON HUNT, former pastor at First Southern Baptist Church, Williamsport, Pennsylvania, has served as the PA/NJ Director of Disaster Relief since Jan. 2016. Before then, he served as a Southern Baptist Disaster Relief volunteer since 1996. Kenton has been active in the Lycoming County Long Term Flood Recovery Committee; the Pennsylvania Feeding Taskforce and the New Jersey Mass Feeding Taskforce; the Recovery Committee and the Manual Revision Committee of Southern Baptist Disaster Relief (SBDR), and PA Voluntary Organizations Active in Disaster (VOAD). Kenton holds a master of divinity degree in church music from The Southern Baptist Theological Seminary, Louisville, Kentucky, and a bachelor of church music degree from Shorter College, Rome, Georgia.

demands readiness, resilience, and a gospel-centered approach.

Designed for disaster relief volunteers, pastors, and church leaders, this breakout equips you to be a Ready Church who prepares before disaster strikes so you can serve with clarity and compassion when it does.

Together, we'll explore:

- Key principles of rapid response from a faith-based perspective
- How to organize and train volunteer teams for high-impact service
- The emotional and spiritual dynamics of crisis response
- Best practices for partnering with local agencies and long-term recovery efforts

You'll leave with practical tools, a clearer plan, and renewed confidence to be the hands and feet of Jesus when your community needs it most. Whether you're leading a response team or building a disaster ministry from scratch, this session will help you move from reactive to ready—anchored in hope and equipped for action.



PRESENTERS: Rob & Sarah Sheldon

PASTOR/PASTOR'S WIFE: GREENCASTLE BAPTIST CHURCH

PASTOR ROB AND SARAH SHELDON have served in full-time ministry for over twenty years. In settings ranging from tiny rural churches to suburban ministry, their passion to see lost souls won for eternity and unwavering commitment to the power of God unto salvation in the life of His followers guides their ministry philosophy. Pastor Rob has been at Greencastle Baptist since July 2021. He and Sarah have two college-age children, and enjoy spending time with their family.



WORKSHOP

From Vision to Action:

Building a Missional Strategy

PRESENTER: Buff McNickle

BRN DIRECTOR OF COMPASSION MINISTRIES & PARTNERSHIP DEVELOPMENT

Buff McNickle, a native of Mobile, Ala., planted Grace Falls Church in the Atlantic County region of southern New Jersey, where he and his core team ministered to those who suffer from substance abuse and homelessness, dancers in the local adult entertainment industry, school children, soup kitchen workers, and more. He has served in full-time ministry as a student pastor, family pastor, minister to singles and young adults, and at the University of Mobile as director of student leadership and involvement. Buff and his wife Cissy are blessed to be the parents of three beautiful adopted children, twin boys, Jedidiah and Judah, and Arabella.

Every church has a heart to make a difference—but without a clear strategy, even the strongest vision can lose momentum. This workshop, filled with successful stories and hands-on strategy development, is for church leaders ready to turn a passion for your community into purposeful, sustainable action through a missional approach to compassion ministry.

We'll explore a simple but powerful framework built around a compassion ministry that is seeking to both share and show the Gospel in impactful ways. In this session, you'll learn how to:

- Align compassion efforts with your church's mission and context
- Evaluate what your church is already doing—and where it might grow
- Build partnerships that extend your reach without burning out your resources

Whether your church is just beginning its outreach journey or seeking to bring greater focus to existing efforts, this workshop will help you move from scattered activity to intentional impact—one step, one strategy, and one story at a time.



PRESENTER: Mary Landis

BRN WOMEN'S MINISTRY CONSULTANT

Mary Landis has been the women's ministry leader at Rolling Hills Church in Verona, Pa., for over 10 years. She has a passion for seeing women come to know Christ, grow in their relationship with Him, disciple one another, and develop deep sister-like bonds to accomplish the work He has for them through the intricate tapestry of their varied gifts. Married to her husband Chad for over 20 years, Mary is a former speech-language pathologist and is extremely blessed to be the mother of three incredible children after years of struggling with infertility. She has a heart for children and people with disabilities, as she lives out some of these struggles daily with her own children. She has a passion for healthy living, environmental stewardship, and homemade everything.



Flooding Every Corner:

Spreading the Gospel Citywide

PRESENTER: Tim Walker

LEAD PASTOR, RESTORED CHURCH, WILKES-BARRE, PA.

TIM WALKER is the lead pastor of Restored Church in Wilkes-Barre, Pennsylvania, an urban church that he planted with a team of friends in 2012. Tim has led Restored to be actively involved and known as a church “In the City, For the City.” Since launching, Restored has never had a Sunday without new people, they have now celebrated 175 baptisms, and they are pursuing a disciple-making movement that saturates their city and region with the gospel. Tim also serves on the USA National Leadership Team for The Timothy Initiative, a global disciple-making, church-planting movement focused on multiplying disciple makers, leaders, and churches to the 4th generation. Tim and his wife Heather have two girls, Lucy and Emily.

What would it take for every person in your city to have a chance to hear and respond to the gospel?

In this breakout, we'll dive into a movement-oriented approach to citywide saturation using Discovery Bible Groups, intentional partner engagement, and scalable strategies for multiplication.

You'll learn how to mobilize everyday believers as disciple-makers, collaborate with city organizations and other churches and ministries, and embed gospel presence into every neighborhood, network, and demographic.

Whether you're just beginning or already engaging your city, this session will inspire and equip you to flood every corner with the hope of Jesus.

*Thank you to our generous
2025 Accelerate Conference sponsor:*



Trail Life

Adventure › Character › Leadership

From Stuck to Strong:

Tackling the Barriers that Hold Us Back

PRESENTER: David Ludwig

BRN DIRECTOR OF DISCIPLESHIP & LEADERSHIP DEVELOPMENT

DAVID LUDWIG, as director of discipleship and leadership development for the Baptist Resource Network of Pennsylvania/South Jersey, is passionate about disciple-making and equipping pastors and leaders to develop healthy, disciple-making churches. David is also a Certified Leadership Coach and has coached pastors, church planters, and other leaders across our network. He holds a master of arts degree from The Southern Baptist Theological Seminary in Louisville, Kentucky; and a bachelor of science degree in religion from Liberty University in Lynchburg, Virginia.

Every church leader faces moments when ministry feels stuck—vision stalls, momentum slows, and personal discouragement creeps in. This breakout is designed to help pastors, ministry leaders, and leadership teams identify top church and financial barriers that are preventing the church from moving forward.

In this session, we'll explore best practices and resources to help your church overcome obstacles and barriers by:

- Evaluating biblical behaviors in the church;
- Exploring financial systems, misunderstandings, and resourcing; and
- Presenting a challenge to create your church's next bold move to overcome.

You'll walk away with suggested tools and resources to assist your church in overcoming the barrier(s) it is facing.

**ALSO FEATURES A TESTIMONY BY
GREG DRAYER, PASTOR OF ROLLING
HILLS CHURCH, VERONA, PA.**



PRESENTER: Andy Weber

BRN DIRECTOR OF FINANCE & OPERATIONS

ANDY WEBER serves as the director of finance and operations for the Baptist Resource Network. He has served with the BRN since 2013 and, for seven years prior to that, Southeastern Baptist Theological Seminary in Wake Forest, N.C., where his role was to oversee the accounting office. Andy holds an undergraduate degree in business from Canisius College, Buffalo, N.Y., and a master of divinity degree in pastoral ministry from Southeastern Baptist Theological Seminary. In addition to Andy's service to the BRN, he is also the founder of Church Financial Management, a ministry designed to assist churches in the areas of financial and administration management.

Future Impact:

Mobilizing My Church for Multiplication

PRESENTER: Kevin Marsico

**CHIEF OF GLOBAL MINISTRY, DYNAMIC CHURCH PLANTING INTERNATIONAL (DCPI);
AND LEAD PASTOR, NORTHSTAR CHURCH IN FREDERICK, MD.**

KEVIN MARSICO serves as the Chief of Global Ministry where he oversees training, global leadership, and DCPI curriculum & translations. Kevin is passionate about mentoring and developing high-level church planting movement leaders to accelerate church planting movements worldwide. He also is a powerful and enthusiastic speaker and has been a pastor at NorthStar Community Church in Frederick, Maryland, since its inception in 2001. Kevin brings relevant, biblical truth to his Sunday messages and inserts humor, passion, and insight into his high-energy teachings.

The future of the Church depends on bold leaders willing to multiply rather than maintain. In this session, we'll explore how to shift your church's mindset from addition to multiplication by cultivating a supporting and sending culture for church planting, identifying and developing church planters, and launching new churches that reach new people.

Whether you're a lead pastor, a team member, or a future planter, this breakout will equip you with practical strategies, reproducible models, and stories of how ordinary churches are making an extraordinary impact. If you're ready to see your church become a multiplying movement, this session is your next step.



PRESENTER: Kyle Canty

SEND CITY MISSIONARY FOR PHILADELPHIA, NORTH AMERICAN MISSION BOARD, ASSISTANT PASTOR, GREAT COMMISSION CHURCH, PHILADELPHIA

DR. KYLE CANTY, a native of Philadelphia, received a bachelors of science degree in Bible and pastoral ministry and a master of science degree in Christian counseling from Cairn University (formerly Philadelphia Biblical University). He also has a master of divinity degree in urban missional leadership and a doctor of ministry degree with a focus on urban missiology from Missio Seminary (formerly Biblical Seminary). He has over 40 years of ministry experience, most recently as assistant pastor at Great Commission Church in Philadelphia. He currently works for the North American Mission Board as the Send City Missionary for the city of Philadelphia, where he oversees church planting efforts in the region.



SERVE **LEHIGH VALLEY**

BAPTIST RESOURCE NETWORK

June
26-27,
2026

SAVE THE DATE!

2 DAYS

40+ PROJECTS

Baptist Resource Network churches are invited to serve the Lehigh Valley, with cities like Bethlehem, Allentown, and Easton, which are among the fastest growing municipalities in Pennsylvania. The BRN is identifying the communities' most pressing needs in partnership with these churches:

- > First Baptist Church, Allentown
- > Iglesia Bautista Hispana, Easton
- > Keystone Fellowship
- > Mission Vida
- > Riverbend Community Church
- > The Vine Calvary Chapel

Projects will go live in March 2026. These projects include opportunities, such as evangelism, light construction, work with immigrants, mobile grill outreach, school and community beautification, and more!

www.servepasj.com | helpdesk@brnunited.org | (717) 652-5856



Trail Life

Adventure › Character › Leadership



65,000+ Members | 1,400+ Troops | 50 States

www.TrailLifeUSA.com

WARNING!

Adding Trail Life to Your Church May Lead To:

• CONTAGIOUS CHURCH ATTENDANCE SYNDROME

Families drawn to the mission of Trail Life are often seeking more than just an activity—they're looking for a community of faith. This may result in a steady influx of new families filling your pews, participating in your ministries, and contributing to the life of your church.

• CHRONIC LEADERSHIP PREDILECTION

Trail Life is a leadership pipeline. Young men are shaped through mentoring and adventure to lead in their communities, while adult leaders deepen their own calling, stepping into greater spiritual responsibility and impact.

• INTERGENERATIONAL MENTORING PANDEMIC

Trail Life sparks an uncontrollable spread of mentoring relationships across generations. Fathers, grandfathers, and church leaders spread wisdom and values contagiously, leaving a legacy of faith and stronger connections.

• CHRONICALLY JOYFUL WOMEN

When men embrace their God-given roles as servant-leaders in their homes and the church, women in your church will feel more supported, valued, and joyful.

• SUDDEN BEARDED MULTIPLICATION

There's something about a camping ministry... expect the smell of campfire smoke to attract and multiply males in your church (particularly of the bearded variety). These men may also come bearing axes and Bibles.

Scan for a
FREE
Tumbler!



Accelerate Vendors

Thank you to our many vendors!



Accelerate Vendors

Thank you to our many vendors!



CENTENNIAL COOPERATIVE PROGRAM

Challenge

**Let's celebrate the
Cooperative Program's
100 years of impact!**

Consider adding an extra \$100 to your monthly, quarterly, or one-time church gift to the Cooperative Program.

Through the Cooperative Program, Southern Baptists join together to reach every person for Jesus Christ. As we celebrate the 100th anniversary of the Cooperative Program, let's ask God to lead Southern Baptists' efforts to make a global impact for the Gospel. Let's make an even greater impact!

**Give locally.
Impact globally.**



**MORE COOPERATIVE PROGRAM GIVING
MEANS MORE CHURCH RESOURCING**

***Imagine the greater impact with
an extra \$1,200, \$400 or \$100!***

100 Churches giving \$1,200 more is \$120,000... 100 Churches giving \$400 more is \$40,000.... 100 Churches giving \$100 more is \$10,000... more dollars accelerating Kingdom movement in PA/SJ and beyond!

35% will be used to fund more international and national missionaries, provide more seminary training, and more!



CP

65% will stay in PA/SJ, funding more ministry projects for the Serve Tours, more ministry and evangelism grants for churches, more PA/SJ missionaries, and more church servicing and resourcing, to name a few!

d+life

livethedlife.com



THE D-LIFE DIFFERENCE

It's not just
a curriculum.

D-Life exists to equip common people to be Christ-like disciple makers.

- **Equip** – D-Life Training provides four hours of excellent training to **equip** disciple makers to lead D-Groups.
- **Empower** – D-Life Journals provide four years of weekly study guides to **empower** believers to lead D-Groups.
- **Engage** – D-Life is not a program; it's a lifestyle. It will **engage** people in disciple-making—anytime & anywhere.



**Interested in learning more?
Contact David Ludwig at
davidl@brnunited.org to
schedule a D-Life Boot Camp
at your church!**



NEW PARTNERSHIP
15% TUITION DISCOUNT
FOR MEMBERS OF COOPERATING BRN CHURCHES

Lancaster Bible College is pleased to announce a new partnership with the Baptist Resource Network. Among the benefits is a 15% tuition discount for members of churches in good standing with the BRN.

Lancaster Bible College, established in 1933 as a private, non-denominational Christian college, integrates biblical truth into over 35 accredited bachelor's, master's, and doctoral programs, preparing students for careers and service to Christ. Students can study on-campus in Lancaster, Pa., or online, guided by expert faculty who are also dedicated mentors.

PROGRAMS INCLUDE:

Biblical Studies
Business Administration
General Studies
Concentrated Bible
Certificate
and More

lbc.edu | admissions@lbc.edu

MISSION STRATEGY



The BRN exists to resource and service churches all over Pennsylvania and South Jersey. It is our desire to take care of pastors and to come alongside churches and help them take the next step God is calling them to take. We do this through a four-step mission strategy:

ASSESS: *Discover Your Current Reality*

An honest and detailed look at your overall ministry, defining where you've been, determining where you are, and discovering where you can go.

ASSIST: *Determine Your Next Step*

Interpreting what you have discovered, prioritizing a next step, and developing fresh strategies to meet the needs and vision of that next step.

ACTIVATE: *Implement Your Next Step*

Encouraging individuals, ministries, and churches to implement strategies and goals developed by the assistance of the BRN and the guidance of the Holy Spirit.

ADVANCE: *Help Others with Their Current Reality*

Enabling churches who exhibit dynamic biblical behavior and movement (moving and leading out) to contribute to the growth and advancement of the Kingdom within the BRN and beyond.

ACCELERATING KINGDOM MOVEMENT

EVERY PERSON EVERY GROUP EVERY CHURCH MULTIPLYING

CAMPERS ON MISSION HAS A NEW CHAPTER IN PENNSYLVANIA

Campers on Mission is a fellowship of evangelical Christian campers with a shared mission: to share our faith and the love of Jesus Christ while camping and participating in various mission activities. We travel in our RVs to spread the Good News, living out the motto of "Sharing Christ As We Go."

Visit our booth to learn more!
www.brnunited.org/campers





**Pastors
are our
priority**



**Churches
are our
focus**



**PASJ
is our
mission
field**

YOUR BAPTIST RESOURCE NETWORK TEAM



DR. BARRY WHITWORTH
Executive Director



**DR. LARRY
ANDERSON**

*Director of Church
Advancement
& Evangelism*



SHANNON BAKER

*Director of
Communications
and Editor,
BRN United*



ELIZABETH BENGE

*Executive Assistant
to Dr.
Barry Whitworth*

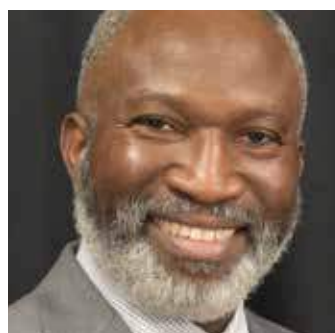

NOELSON CHERY

*Ethnic Church
Advancement
Consultant,
Philadelphia*



**JOHN
COPE**

*Send Network
Director PA/SJ*



GREG DRAYER

*Church
Advancement
Consultant,
West Region*



ROBERT FONTELL

*Church
Advancement
Consultant,
Philadelphia Region*



KENTON HUNT

*Director of
Disaster Relief*



CHUCK KNOX

Legacy Coach



CHRISTY KRAUS

*VBS/Kids' Ministry
Consultant*



MARY LANDIS

*Women's Ministry
Consultant*



DAVID LUDWIG

*Director of
Discipleship and
Leadership
Development*



MACALA MAYS

*Communications Associate,
Associate Editor,
BRN United, and
Podcast Producer*



BUFF MCNICKLE

*Director of
Compassion Ministry
& Partnership
Development*



BRIAN MUSSER

*Collegiate Minister,
Drexel University/BRN
Next Gen Consultant*



ERIC REIBER

*Collegiate Minister,
Penn State (main
campus)/BRN Next
Gen Consultant*



ROB SHELDON
*Church Advancement
Consultant,
Southern
Central Region*



DEBBIE TOONE
*Hub Support
& Bookkeeper*



JOSEPH VELARDE
*BRN Send Network
PA/SJ
Recruitment Leader*



ANDY WEBER
*Director of Finance
and Operations*



BETH WHITWORTH
*Ministry Wives
Consultant*



R. DAVIS YOUNTS
Legal Counsel



LORI ZEPPUHAR
*Help Desk &
Hub Support*

BRN Executive Director Barry Whitworth was interviewed on LightHouse TV's "Morning Light" program on June 5. Screen grab.



BAPTIST RESOURCE NETWORK

MINISTRY REPORTS

Everything we do at the Baptist Resource Network (BRN) centers on four key parts of our strategy to help churches *accelerate Kingdom movement*.

ASSESS:

Discover Your Current Reality

An honest and detailed look at your overall ministry, defining where you've been, determining where you are, and discovering where you can go.

ASSIST:

Determine Your Next Step

Interpreting what you have discovered, prioritizing a next step, and developing fresh strategies to meet the needs and vision of that next step.

ACTIVATE:

Implement Your Next Step

Encouraging individuals, ministries, and churches to implement strategies and goals developed by the assistance of the BRN and the guidance of the Holy Spirit.

ADVANCE:

Help Others with Their Current Reality

Enabling churches who exhibit dynamic biblical behavior and movement (moving and leading out) to contribute to the growth and advancement of the Kingdom within the BRN and beyond.

2025

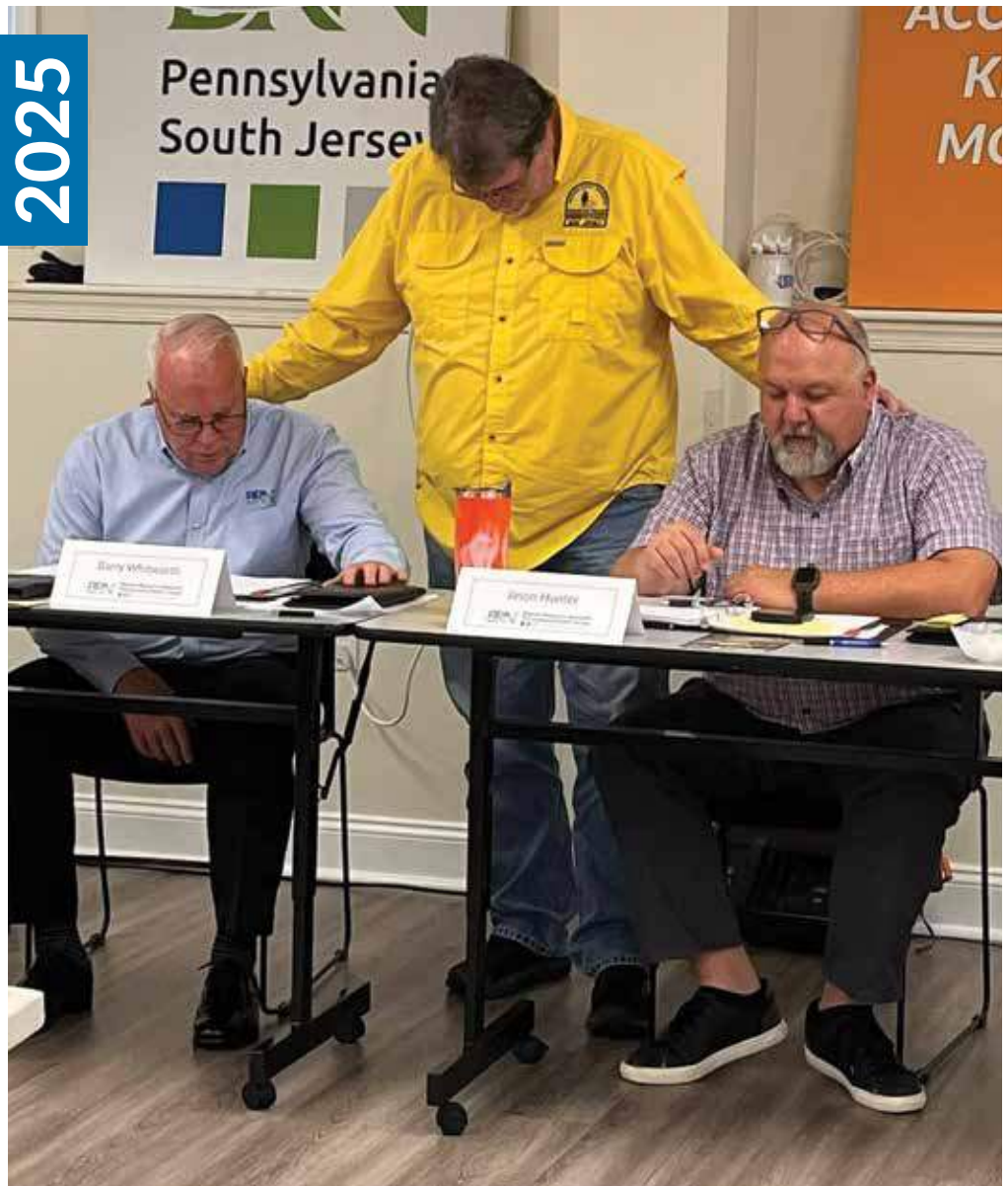

At the BRN, we have a clear vision of every church within our Pennsylvania/South Jersey geography becoming a healthy, multiplying church.

- CHURCH ADVANCEMENT
- COMMUNICATIONS
- COMPASSION MINISTRIES
- DISASTER AND CRISIS RELIEF
- FINANCE AND OPERATIONS
- LEGACY PLANNING
- NEXT GEN MINISTRY
- WOVEN WOMEN

CHURCH ADVANCEMENT

BRN's Church Advancement leaders share 2025 highlights

There were some great successes this year. One of those successes is the number of grants for church evangelism projects that have been awarded.

As of early August, 106 grants have been awarded to existing churches, church plants, and collegiate ministries.

Another huge success was the Advance Conference, featuring Pastor James Roberson, Lead Pastor, The Bridge Church, Brooklyn, N.Y., and Dr. Lee Clamp, associate executive director-treasurer, South Carolina Baptist Convention.

The BRN also hosted several Pastor Blessing events simply to encourage pastors and their families.

BRN Church Advancement Director LARRY ANDERSON and the team have assisted over a dozen churches in implementing the Next Level Blueprint, a strategic five-year plan to help churches see their visions come to fruition.

As the Chair of Mansion Hope, he and other BRN pastors were instrumental in seeing Mansion Hope bless the impoverished children within the Strawberry Mansion community with gifts over the holidays as well as bring in a team of missionaries to assist in projects to beautify the school. They additionally provided 500 filled back-to-school backpacks to bless the students of William Dick Elementary School in Strawberry Mansion. Anderson was invited by the North American Mission Board's Send Relief division to speak on a panel in Georgia to share how the BRN in general and Great Commission Church specifically, execute compassion ministries throughout their communities.

He also spoke at several BRN churches this year to help them celebrate pastoral and church anniversaries as well as served as a Homiletics professor and guest speaker in Zambia in a collaborative foreign mission initiative hosted by Pastor Ricky Wilson and the Africa Partnership.

STEVE SHELDON, church advancement consultant for the Southern Central region, made multiple contacts with the churches in the seven counties that make up the region. He visited over a dozen churches, and, along with his wife Kathy, shared blessing bags with the pastors and wives. He also had Next Level and Next Steps conversations with several pastors. Steve participated in both the 2024 Accelerate and the 2025 Advance Conferences, as well as the Serve Wilkes-Barre/Scranton tour that was held in June. Steve and Kathy, along with several of the Southern Central churches, participated in this weekend of mission projects.

GREG DRAYER, church advancement consultant for the west region, noted 2025 was a blessed year of seeing some of our churches return to ministries with a renewed vision and effort. He saw our churches envision and plan for new ministry opportunities through tools like the Next Level Blueprint. Through the winter and spring, he saw a few churches begin working towards opening their pulpits for those from some of our other SBC churches to have the opportunity to preach. Some of these opportunities were to help the new associate pastor candidates grow in their preaching experience and leadership, and other times, it was

for the pastor of the church to be able to take some time off and know that his people will still receive a clearly communicated word from God to His Church. During the summer months, they saw a number of churches redeploy their efforts of community outreach through a reimagined VBS week as well as plenty of community engagement opportunities at local parks and community days. They also had a series of pastor blessing lunches with pastors whose churches are looking to reimagine and then plan for different ways of reaching the lost through a focused 3 to 5-year plan for ministry. They utilized the BRN's Next Level Blueprint to help guide the discussion with their leaders to best think through all the necessary steps to help them reach their ministry goals. A couple of churches reached new levels in their ministries by the giving and participation rise amongst their congregations. There were a handful of churches from the west that made the trip to Scranton/Wilkes-Barre to help with ServePASJ's efforts to be a ministry presence to those communities. We are excited for fall opportunities of workshops and gatherings where our pastors can learn from each other and encourage one another in our region's continued efforts to see God's Kingdom grow and have an eternal impact on the lives that God has entrusted to us.

NOELSON CHERY, BRN's ethnic church consultant organized a Pastors Blessing for pastors and other church leaders in the greater Philadelphia region. It was a time of worship, reconnection and encouragement. Among

other activities, all participants received Sunday school materials and enjoyed a presentation on the benefits of using the Next Level Blueprint for strategic planning. One of Noelson's focuses this year was supporting VBS outreach to the next generation. He was able to help orchestrate or support several churches, including, but not limited to, First Haitian Metanoia Baptist Church, Cambodian Baptist Church and New Creature Baptist Church, to name a few. Noelson also had the pleasure of attending the 19th anniversary of Agape International Baptist Church with Pastor Jackie Wleh and his wife Johnetta.

GERALD WATERS, Philadelphia's Church Consultant Waters worked with other BRN churches who partnered with Philadelphia-based resource agencies to support residents affected by the January 31 plane crash in Northeast Philadelphia. Pastor Nathaniel Holder of St. John Memorial Baptist Church, along with State Representative Jared Solomon and Calvary Christian Church with Pastor Robert Fontell, provided practical aid and spiritual encouragement to those who lost their homes. The event was an opportunity to pray with many and to share the hope of Jesus Christ. As a result, seven individuals made the decision to receive Christ as their Lord and Savior. In addition, Waters connected mission teams from Alabama to help support joint summertime evangelistic outreach initiatives for Third Eternal Baptist, Harambe Baptist Church, and Haitian Evangelical Baptist Church.

GIBSON LARGENT, Greater Philadelphia church advancement consultant admits he didn't fully grasp the level of intentionality, effort, and hard work the Church Advancement team pours into supporting churches until he joined the team in January. As a newcomer, he said he was immediately struck

by how united and focused the BRN team is in equipping and encouraging pastors and churches across Pennsylvania and South Jersey. He learned how to walk alongside pastors in evaluating their current church health and identifying practical next steps toward greater fruitfulness.

These next steps often took the form of outreach initiatives—block parties, camps, volunteer equipping events, local and global mission trips, and preaching series, among others. Some churches didn't stop at the next step; several began pursuing "next level" goals aimed at multiplying their Kingdom impact. For example, a few churches in the Philadelphia suburbs began planting new churches and moving toward becoming reproducing congregations for the first time. Others took a hard look at their church health—identifying areas that once showed signs of decline and pursuing renewal. A few even completed full health assessments to better understand barriers to growth and fruitfulness.

There were other memorable highlights as well. He had the privilege of regularly praying with and for 30 pastors, noting these men are among the hardest-working leaders he's encountered. They care deeply for those they shepherd and are eager to see the Gospel transform their communities. Most are actively engaged in outreach—hosting camps, organizing mission trips, and leading community service projects to seek the welfare of their neighborhoods. While many are weary from long seasons of faithful ministry and in need of encouragement, others are energized by fresh vision, and their enthusiasm is contagious.

Largent said serving on the Church Advancement team has been an incredible personal blessing. He's been able to pray with and support pastors, pass along

helpful ministry ideas, encourage those feeling stuck, and celebrate with those experiencing renewed purpose. Perhaps most impactful for him, he said, was learning practical tools to help churches evaluate where they are and discern what steps to take next in pursuing gospel impact. Largent recently vacated the position as a BRN consultant after accepting a pastorate in Texas.

BUFF MCNICKLE, church advancement consultant for South Jersey, also said 2025 was a great year of ministry and impact in South Jersey. He had the opportunity to take out and bless several S.J. pastors and wives during the year to encourage and pray for them as they serve selflessly in the region. He hosted a summer-ending families event in August where families could come, play, relax, and connect with other pastors in the region. It's always a great time of fellowship and a simple reminder that we are not alone, McNickle said.

He also gathered some of the Next Generation leaders and those who are working with students in the region back in May to begin to pray and see how to unite students in South Jersey. They are praying and looking forward to doing some events in 2026 with students from all over Southern New Jersey.

McNickle also helped bring ministry partners from Alabama, Louisiana, and Florida to work with some of the churches and their outreach efforts. These teams helped with providing gifts for families in Camden, helped lead sports camps on military bases, and worked on some of our churches. He saw many of the churches utilize evangelism grants and use those resources to strategically plan BOLD events to plant the Gospel in South Jersey. "God is at work here in South Jersey and I can't wait to see what 2026 looks like," McNickle said.

MICHAEL NERGER, Southern Central Support shared some of the

BAPTIST RESOURCE NETWORK OF PA/SJ CHURCH ADVANCEMENT TEAM IS HERE FOR YOU!



DR. LARRY ANDERSON
DIRECTOR OF CHURCH
ADVANCEMENT & EVANGELISM



DAVID LUDWIG
DIRECTOR OF DISCIPLESHIP &
LEADERSHIP DEVELOPMENT



ERIC REIBER
COLLEGIATE/PENN STATE
(ALL REGIONS)



BRIAN MUSSER
COLLEGIATE/DREXEL
(ALL REGIONS)



GREG DRAYER
WEST REGION



MICHAEL NERGER
SOUTHERN
CENTRAL REGION



CHRISTY KRAUS
VBS/KIDS MINISTRY
(ALL REGIONS)



ROBERT FONTELL
GREATER PHILADELPHIA
REGION



MARY LANDIS
WOVEN WOMEN
(ALL REGIONS)



ROB SHELDON
SOUTHERN CENTRAL
REGION



NOELSON CHERY
ETHNIC CHURCHES



BUFF MCNICKLE
SOUTH JERSEY
REGION

The BRN is committed to helping your church advance to new levels—in every region, ethnic and age group, and among women and collegiate students.

Please reach out to the Help Desk at helpdesk@brnunedited.org or 717-652-5856 to schedule a consulting appointment today!

David Ludwig, in new role, focuses on discipleship and leadership development

DAVID LUDWIG, BRN director of discipleship and leadership development, reports that he is encouraged by having over 150 conversations about disciple-making this year. Along with those conversations, David provided discipleship training (D-Life) for three churches (in Pittsburgh, Reading, and Trucksville, Pa.), equipping over 80 people to be disciple-makers. David is praying for God to begin a Disciple-Making Movement across our two-state network! He also has been working with pastors to develop discipleship pathways and help them create leadership pipelines

tailored to their church's unique needs. In addition, David has been discipling men and coaching pastors and leaders across the BRN network and assists churches in conversations about taking their next steps to achieve their next levels. David served as the transitional pastor at Pittsburgh Baptist Church, along with training Pastor Search Committees and advising them as they seek God's will in finding their next pastor. To that aim, he has created a Pulpit Supply package (brnuned.org/pulpit) for those interested in acquiring or serving as pulpit supply for BRN churches. He is a

part of the leadership team for the SBC Revitalization Network and belongs to the State Discipleship Network and the Disciple Leaders Network. He currently is working with Gary Jennings from CityLife Ministries, collaborating with other team members, about ways that Jennings can assist our churches in starting disciple-making groups in apartment communities. In between other projects, he is researching alternative methods to provide training, especially for bi-vocational pastors with limited schedules.

greatest blessings of his job were spending time with pastors and celebrating what God was doing all throughout the region. In addition, he enjoyed praying with them throughout the week, celebrating how God was working, as well as praying for God's people as they grew in their relationship with Him.

JOSH COLDREN, former Northern Central church advancement consultant, also agreed this past year was an exciting year. Most notably, churches in his region were able to host Serve Wilkes-Barre/Scranton, where over 400 volunteers completed over 50 different projects and shared many Gospel conversations. In addition, he was able to assist several pastors in finding pulpit supply, interim pastors, as well as many one-on-one conversations with pastors on how they can take their next steps to be who God has called them to be as well as helping churches talk about their goals for this next season.

As with any organization, some of the above pastors have transitioned to serve elsewhere or be more intentional in their current ministries. Accordingly, the BRN has spent part of the year considering new candidates to serve on the Church Advancement team. One pastor, ROB SHELDON from Greencastle Baptist Church, will fill the role vacated by Steve Sheldon, who retired on September 1. ROBERT FONTELL, former church advancement consultant in Philadelphia, initiated the opportunity to serve again with the BRN. He will take on the role vacated by Gerald Waters, who will now focus on his church ministry full-time.

Please pray for each of these consultants, who give extra from their own ministries to make a difference for the churches in our region.



A promotional poster for the Baptist Resource Network's Vacation Bible School (VBS) training. The poster features a blue background with a white silhouette of a child pointing upwards towards a starry sky. At the top, a yellow banner reads "BAPTIST RESOURCE NETWORK VACATION BIBLE SCHOOL". Below the banner, the text "VBS TRAINING" is prominently displayed in large white letters. Underneath, it says "APRIL 25 | BRN Hub" in white, followed by "POSITION YOUR CHURCH TO REACH" in yellow. At the bottom, the phrase "MORE CHILDREN" is written in large yellow letters. A QR code is located on the right side of the poster, near the child's silhouette. At the very bottom, a small white text line provides the website and contact information: "brnuned.org/vbs | 4620 Fritchey St., Harrisburg | (717) 652-5856".

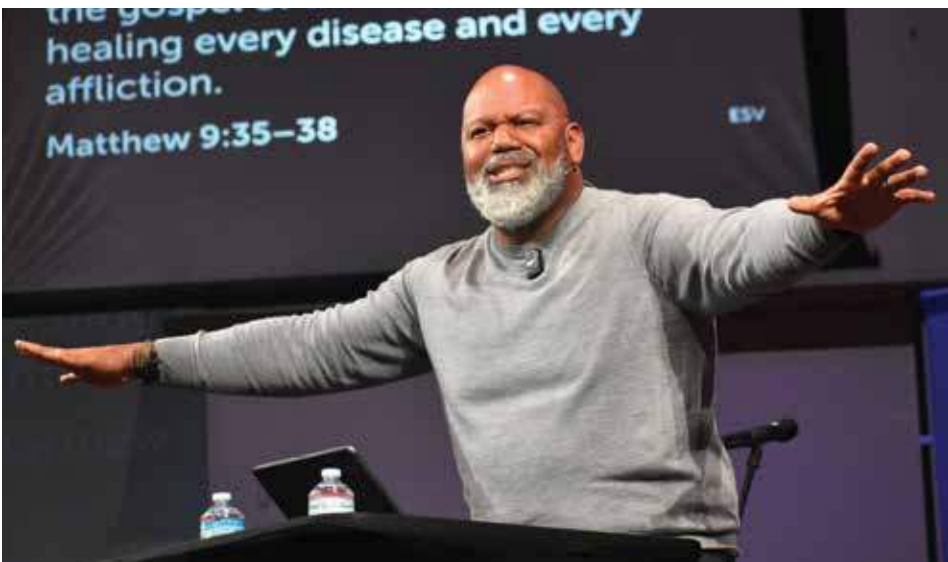

Baptist Resource Network

From Ideas to Impact: Training, Strategies, & Support for your KidMin.

Reach Kids. Reach Families.
Reach Your Community.

How Can I Help?

- Train
- Coach
- Strategize
- Create

**VBS
CONSULTANT
CHRISTY KRAUS**

TODAY

**LET'S
TALK!**

 christyk@brnunited.org
 www.brnunited.org



Baptist Resource Network of Pennsylvania/South Jersey

PULPIT SUPPLY

A new resource for those interested in serving as or acquiring supply preachers.

Apply for Pulpit Supply Role:



Whether you are a retired pastor, seminary student, or minister between calls, we would love to hear from you! Before applying, please consider the requirements and policies found at brnunited.org/pulpit.

Request Pulpit Supply for Your Church:



Whether you're planning a vacation, attending a conference, or just need a break from the pulpit, we are compiling a reliable, diverse list of supply preachers ready to serve congregations across the region.

We seek to have pulpit supply preachers who are available for one-time, short-term, or seasonal coverage, and are flexible with travel and service formats (contemporary or traditional, in-person or online).

Contact Us:



717-652-5856



helpdesk@brnunited.org



brnunited.org/pulpit

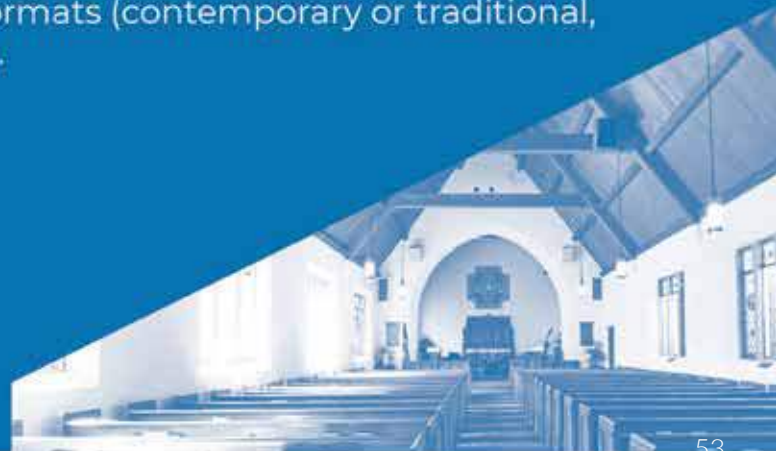

COMMUNICATIONS

By Macala Mays and Shannon Baker

The Baptist Resource Network (BRN) Communications Team had an exciting start to 2025 as they started the year by adding Macala Mays, formerly a contracted consultant, as a full-time staff member.

In January, Mays assumed the role as communications associate/associate editor of *BRN United*. In this role, she carries out many of the journalistic responsibilities for the BRN and offers essential support to our Communications Team.

In the area of news coverage, the BRN Communications Team hit the ground running in January when breaking news was reported out of Philadelphia following a devastating plane crash.

As the nation turned its eyes to Northeast Philadelphia, the BRN was able to appropriately communicate what churches on the ground were doing in response as well as inform believers across the nation how they could be praying for those involved. This story was picked up by several national outlets, including Baptist Press, *Biblical Recorder* and *The Baptist Paper*.

Additionally at the national level, Mays and BRN's Communications Director Shannon Baker served on the Southern Baptist Convention's (SBC) annual meeting media team in June. Mays also represented the BRN as the vice president of Communications for the Baptist Communicators Association (BCA), a group that is made up of Baptist communicators from across the country. Heading into 2026, both Baker and Mays will be serving as BCA officers. Mays will continue in her role, and Baker will serve as

program chair, planning the BCA annual meeting in Pittsburgh in April 2027.

During 2025, the BRN also received national recognition for its Serve Wilkes-Barre/Scranton coverage, which took place at the end of June. For this statewide missional effort, the Communications Team partnered with local churches to provide day of coverage, designed and distributed promotional items, built the ServePASJ web page and produced post ServePASJ content, such as a highlight reel, wrap up article, photo gallery, video testimonies and a special edition of *BRN United*.

Along with the Serve Wilkes-Barre/Scranton edition of *BRN United*, the BRN has published four other special edition newsletters, and digitally delivered a total of 41 issues of *BRN United* thus far this year. At the time of this publication, *BRN United* averaged a weekly 10.63% open rate with readership remaining around 1,775.

BRN United has continued to provide weekly news updates and valuable resources for pastors and churches serving the Pennsylvania/South Jersey area. This year, these news stories included reporting on BRN events, such as a Disaster Relief fundraising banquet, Serve Wilkes-Barre/Scranton and the Advance Evangelism Conference.

Other stories included honoring two collegiate missionaries for their legacy of ministry, welcoming new pastors and churches into the BRN Family, and following the adventures of a multi-church mission team to Zambia.

In addition to *BRN United*, the Communications Team has helped produce 10 editions of the Woven Women newsletter and nine editions of the #RenewPASJ newsletter. The team also aided in the rebrand of the #RenewPASJ newsletter, which was previously known as the #TransformPASJ newsletter.

In addition to the journalistic efforts, the Communications Team has had a heavy behind-the-scenes design schedule this year. They developed artwork and promotional material for multiple BRN events, Executive Board meetings, and new initiatives. These included the Summer Strategy Workshop, Deacons' Training, VBS training, Disaster Relief advanced trainings, multiple discipleship/leadership discipleship events, First Steps Gatherings for newly affiliated churches and pastors, Woven Women events, new wellbeing resources, and more. Most notably, the team produced a 2024 *Impact Report*, which showcases the BRN's progress on five-year goals.

The team also produced nearly 150 videos thusfar, ranging from the monthly Top Five emphasis to weekly communications from BRN Executive Director Barry Whitworth and other team members. They additionally provided support for videos produced by Lighthouse TV and others.

The team also produced *all* the media and web platforms for the Amplify Conference, Advance Conference, Disaster Relief Fundraising Banquet for the new BRN Response and Relief Center in Winfield, Pa., Serve Wilkes-Barre/



One Day Closer, premiered May 29, 2025



Scranton, the LovePASJ Impact Funds Week of Prayer for Missions, The Battle Belongs to the Lord ministry couples retreat, and the Accelerate Conference. These items included multiple digital and printed ads and programs, videos, and other assets. In addition, Baker spent much of her year coordinating and producing these events.

Looking forward, the BRN Communications Team is working on a number of projects that will

round out 2025 and usher in 2026 with a strategic and creative flare. To name just a few, these exciting projects include the 52-Week Prayer Guide many of you will receive at Accelerate, collegiate missionary prayer cards, a Next Level Journey initiative, and Serve Lehigh Valley materials.

As always, the BRN Communications Team's prayer is that the resources we produce and the content we publish will be

effective in aiding our pastors and ministry leaders. We earnestly hope that the stories the Lord allows us to tell will greatly encourage our BRN Family to continue in step with the Spirit here in Pennsylvania/South Jersey. Thank you for allowing us to serve you, BRN Family!

"Declare his glory among the nations, his marvelous works among all the peoples! For great is the Lord, and greatly to be praised; he is to be feared above all gods" (Psalm 96:3-4).

COMPASSION MINISTRY

By Buff McNickle, BRN Director of Compassion Ministries and Partnership Development

Compassion ministry is a key component for any healthy church that is seeking to plant the Gospel. Compassion ministry, at its core, is simply followers of Jesus and His church showing God's love in action. It's moving past the talk and ideas to going and showing the world who Jesus is and how much He loves them. We can do this in simple ways, but if we are led by the Spirit, it can produce incredible results.

SUMMER STRATEGY

We started the year off in 2025 asking churches to dream with us. We asked them to consider their communities and their churches' schedules and ask a simple question, "What could happen this summer if we developed a plan to see God move in our church and our community through compassion ministry?"

We had churches from all over Pennsylvania and South Jersey join us for a *Summer Strategy Workshop* where they worked and developed a strategic plan to take home with them so they could mobilize their church to reach their community during the summer. It was great to hear the different needs that existed in their communities, the creative approaches they were going to try to meet those needs, and the vision they had to see God move because of their efforts. It was BOLD, and it was what we love to see.

Churches who came were planning things like sports camps,

mobile grill outreaches, community partnerships, VBS, block parties,

"Vision without strategy remains an illusion."

Lee Bolman

and so much more. Many of these churches were planning things they have never done before. They set goals that focused on specific things they could rally their church to reach, goals such as serving "this many people this summer" or having "this many gospel conversations" and "praying with this many people." They didn't stop there. They set goals they couldn't achieve apart from God doing what only He could do, specifically asking God to "save so many people" or "see this many people follow Jesus through the waters of baptism."

It has been great to see churches like Mt. Wolf, First Baptist Church of Clarion, New Life, God's Field, Nebo Baptist, First Baptist Church of Rochester, and others doing the very events they planned back in February and reaping the results this summer.

SERVE WILKES-BARRE/SCRANTON

One of the major events this past year that both highlights and engages our churches in compassion ministry is the

ServePASJ emphasis we have every year. We go to a particular region in our network and work with our BRN churches there to make an impact with the Gospel to accelerate Kingdom movement.

It is also a great time for all of our BRN churches to come together in one place and demonstrate the power of our network.

This year, we had 48 BRN churches come, which equaled 539 volunteers over 2 days. We completed 54 projects that equaled over 10k volunteer hours. Yet, the most amazing statistic of the weekend was the fact that we had over 1,500 Gospel conversations, served over 8,500 people, and saw 32 people give their lives to Christ that weekend.

We praise God for all He did, and we love that His work and movement didn't stop after those two days in late June. We have reports of churches who were inspired by what they did in Wilkes-Barre/Scranton and have got back home to their church and their context and started doing similar works of compassion ministry at home.

This is what the weekend is all about. It is intended to be a movement and not a moment. Mark your calendar today for next year and mobilize a group from your church to come and participate in the Serve Lehigh Valley experience on June 26-27, 2026. You can learn more at servepasj.com.



Photos from June 27-28 Serve Wilkes-Barre/Scranton tour and the February Summer Strategy workshop.



DISASTER & CRISIS RELIEF

By Kenton Hunt, BRN Disaster Relief Director

The following are BRN Disaster Relief highlights for 2024-2025:

- 27 volunteers received basic DR training in Feeding, Chain Saw, Flood Recovery, and Shower/Laundry.
- 102 volunteers have been deployed to 2 in-state responses and 7 out-of-state responses.
- 8 trailers and vehicles have been deployed to the same responses.
- 6 churches have entered the Ready Church certification process.
- Disaster Relief feeding volunteers, the Rapid Response Kitchen, and three Shower/Laundry trailers were deployed in support of Serve Wilkes-Barre/Scranton.
- All 3 Shower/Laundry units, the Rapid Response Kitchen, and a Western Shelter have been utilized to support various ministry efforts of 6 different churches.

Disaster responses include Hurricanes Helene and Milton, to which we deployed 65 volunteers to Sarasota, Fla. (feeding), Beech Island, S.C. (feeding), Anderson, S.C. (chainsaw), Spartanburg, S.C. (chainsaw), and Swannanoa,

N.C. (flood and chainsaw). In addition, we deployed to Welch, W. Va. (flooding), Westernport, Md. (flooding), York, Pa. (flooding), and Susquehanna, Pa. (chainsaw).

On May 1-3, BRN Disaster Relief hosted the first Region 3 Blue Hat Training in the BRN Training Center. We had 40 participants from four state



conventions.

On May 30, Winfield Baptist Church hosted the Building Our Future banquet to raise building funds for the proposed BRN Disaster Relief Response Center. Going into the evening, we received \$147,000. As a result of the banquet, our balance soared to \$300,000. As of the writing of this report, our balance stands at \$400,000! Praise the Lord!!! The goal for the building fund is \$500,000. Beyond that, our goal is to raise \$1 million for the Disaster Relief Legacy Fund to support the ministry well into the future. Groundbreaking for the Center may take place

in late Fall 2025!

The PASJ fleet currently includes 2 Mobile Kitchens, 8 Recovery Units (Flood, Chainsaw, Temporary Roofing), 3 Shower/Laundry Units, 1 Command/Communication Unit, 1 Pressure Wash Trailer, 1 Fuel Trailer, 1 Water Purification Unit, 2 Western Shelters, 2 support trailers, a 12-passenger van and a pickup truck. Ownership of these assets belongs to churches and the BRN.

As a result of all of these disasters, the gospel has been presented in each situation to the people who were served. We rejoice that we were able to see God save people through our witness and work. In nearly all cases, we were able to work alongside a local church or church planter to do follow-up and engage local government, residents, and other faith-based and community responders. We praise the Lord for such opportunities to further the Kingdom of God!

Please keep Disaster Relief efforts in your prayers. It is a powerful ministry that brings light into darkness, order into chaos, and Good News into hopeless situations.

Inset photo: Penn State students minister in the aftermath of Hurricane Helene.



Photos from May 30 Disaster Relief banquet to raise funding for future site of the BRN Response and Relief Center in Winfield, Pa.



FINANCE & OPERATIONS

By Andy Weber, BRN Director of Finance and Operations

We have been busy over the past year working on several behind-the-scenes activities that are designed to help enhance the BRN's servicing and resourcing of churches in Pennsylvania and South Jersey. Though this is not an exhaustive list, we are happy to share the following.

New State Annual Filing Requirement for Churches in PA

2025 marked the beginning of required annual reports for churches (and all organizations) in Pennsylvania. This reporting applies to all PA churches and failure to comply could result in an automatic dissolution/termination/cancellation of the organization and loss of the protection of the organization's name, meaning a new organization can come in and take the name previously used by the church. The BRN provided resources to assist churches in completing the filing and fielded many phone calls assisting churches through this new process.

The annual filing is free for churches, and the annual deadline is June 30. Please make sure your church has added this to its annual calendar. To learn more about this filing requirement, please visit the state's website at <https://www.pa.gov/en/agencies/dos/programs/business/types-of-filings-and-registrations/annual-reports.html>.

Pastoral Wellness and Counseling

Beginning in 2025, the BRN joined with Converge Coaching and MyCounselor.Online in partnership to

provide counseling and coaching services to BRN lead/senior or campus lead pastors. The counseling and coaching offered under this agreement is for spiritual, emotional, and mental wellness. The Baptist Resource Network will subsidize coaching or counseling as follows:

Year One: The BRN will cover 6 sessions of coaching or counseling per year at a discounted rate of \$140 per session. The BRN will cover 80% (\$112) of each session, and the pastor is responsible for paying the remaining 20% (\$28 per session). Additional sessions can be continued, but the pastor would be responsible for 100% of the cost after completing the original six sessions at \$140 per session.

Year Two, if needed: The BRN will cover 50% (\$70) of each session, and the pastor is responsible for paying the remaining 50% (\$70 per session).

Who Qualifies? This Coaching/Counseling benefit is limited to the first 50 lead/senior or campus lead pastors from cooperating BRN churches. Cooperating churches are those who are currently and actively giving to the Cooperative Program and have filled out the Annual Church Profile (ACP) for the most recent year. Slots are available per year on a first come, first serve basis. To learn more, go to brnunited.org/counseling.

Pittsburgh-Warren Mission House

Through a partnership with the South Carolina Baptist Convention and South Carolina churches, we have completed the renovation at the Pittsburgh-Warren Mission House. Under the leadership of Pam and Randy Creamer, teams from churches mainly in South Carolina and Pennsylvania came and added bathroom space, designed the first floor to be more



open concept, updated the paint and flooring, and modernized the house to the current day. Our hope is that the house will be an even better location for teams to utilize in order to do mission work in the Pittsburgh, Pa., area. Please help express our appreciation to the Creamers and the S.C. Baptist Convention. We are so grateful for their sacrifice and willingness!

Work of the Executive Board

The Executive Board of the BRN welcomed 3 new members who filled vacancies from expired terms, and following the messenger vote last fall, they welcomed Jason Hunter, pastor of First Baptist Clarion, as the board president for 2025.

The board has been hard at work revising organizational policies, working with the SBC to ensure there is adequate representation on entity boards from PA/SJ, approving an associate member status with the BRN, working on a partnership with Lancaster Bible College, reviewing financials, approval, and work on the BRN's Rapid Response and Relief Center, and building financially for the future of the BRN.

Partnership with Lancaster Bible College

As of July 2025, the BRN has formed a partnership with Lancaster Bible College. Details about this partnership will be publicized in the coming months. One of the main benefits of the partnership is a 15% tuition discount for any person who is a member at a cooperating BRN church who is in good standing with the BRN. We are excited to partner with the college to offer this benefit, amongst others, to BRN churches.

Thank You to our Churches

The BRN is so thankful for you and your generous and gospel minded heart. May we continue to work together to push against the darkness and advance the gospel in Pennsylvania/South Jersey, and beyond. Your giving is making a huge impact in our region and around the world!





CONVERGE COACHING

COACHING

A safe, confidential space where leaders can express themselves freely and without judgment.

COUNSELING

Integrating biblical and psychological principles to help leaders navigate life's challenges.

COACH TRAINING

Dynamic, hands-on training led by expert facilitators - delivered onsite or via Zoom.

EXECUTIVE COHORTS

Confidential spaces for strategic collaboration - where visionary peers tackle complex challenges and shape the future of their organizations.

The Baptist Resource Network (BRN) has created a partnership with Converge Coaching and MyCounselor.Online, designed to offer recipients opportunities for spiritual, emotional, and mental health wellness. BRN will subsidize coaching or counseling, geared toward the lead/senior or campus lead pastor. There are 50 slots available per year for lead/senior or campus lead pastors on a first come, first serve basis.



COUNSELOR[®]

FAITH-BASED ONLINE THERAPY

CHRIST-CENTERED. SPIRIT LED.

Our model, Neuroscience Informed Christian Counseling® (NICC), is rooted in biblical truth and backed by the latest research in emotional and brain science. We help you understand what's really going on under the surface—and how Jesus is already moving toward you with love, healing, and hope.

100% ONLINE. ALWAYS ATTUNED.

Access therapy from the comfort of your own home. Whether you're a homeschool parent, a missionary on the move, or just need scheduling flexibility, we make counseling convenient and confidential.

CLINICALLY EXCELLENT. BIBLICALLY FAITHFUL.

Every NICC therapist completes an intensive postgraduate residency—so you're not just getting "Christian-flavored" therapy. You're getting deeply trained, supervised professionals who understand both your story & your soul.

PERSONALIZED MATCHING. REAL RESULTS.

No cookie-cutter pairings here. Our Matching Meeting is *risk-free* and designed to match you with the therapist who fits your unique needs and values. And it works: 93.6% of clients report a successful outcome from their counseling experience.

The Baptist Resource Network (BRN) has created a partnership with Converge Coaching and MyCounselor.Online, designed to offer recipients opportunities for spiritual, emotional, and mental health wellness. BRN will subsidize coaching or counseling, geared toward the lead/senior or campus lead pastor. There are 50 slots available per year for lead/senior or campus lead pastors on a first come, first serve basis.

Learn more at brnunited.org/counseling



LEGACY PLANNING

Hi, my name is Chuck Knox, and I am the Legacy Coach for the BRN. I retired from full-time ministry in December of 2018. During the last decade of full-time ministry, I traveled nationally presenting Legacy workshops in local churches for a large, national church lending organization. During that time, we helped individuals establish almost \$20 million in legacy gifts to benefit their local churches as well as the ministry that sent me out.

After I retired, I thought my time would be spent with my wife and grandchildren traveling and enjoying what was left of my time on earth. However, God had other plans. Because I had been traveling extensively for almost a decade, we had lost touch with our home church and decided to visit other churches in our area. One of the churches we visited was Harvest Community Church in Kittanning, Pa. It was different than the churches we had attended before but in a good way. They were interested in growing locally but their overall goal was to increase the health and size of God's church everywhere. We identified with that concept and quickly connected and began the process of joining them in their efforts. When the leadership found out my work background, they asked if I would be willing to become a part of the staff and make the Legacy Workshops available in the local church. Harvest is one church in four locations so they wanted to offer the Legacy Workshop to the local congregations as well as other churches in the area. During the four years working part-time for Harvest, we provided 13 workshops attended by almost 300 individuals and identified just over \$750,000 in legacy gifts that will benefit Harvest in the coming years.

As a member of BRN, Harvest offered this Legacy Workshop to other members of BRN and at the beginning of 2023, I left Harvest and joined the BRN team on a part-time basis. In the past two and a half years, we have presented 11 workshops throughout Pennsylvania and South Jersey that were attended by over 180 individuals. Those individuals have indicated that they will be leaving over \$150,000 in Legacy gifts to some of those local churches.

This Legacy Workshop is being offered to all members of

the BRN. It is a 90-minute workshop that can be hosted by one church or a group of churches in the same community.

Many churches have also found that the Legacy Workshop can be a great outreach tool to encourage those from outside the church to attend. Included with the workshop is a workbook and a study guide to help answer questions and guide individuals or couples through the process of establishing a godly plan to care for the assets that God has entrusted them with. The workshop is being offered free of charge to all members of BRN. The only expenses that the church is responsible for is the cost of the materials (\$25/set) and all travel expenses.

BRN has also subscribed to an online will and Power of Attorney drafting program that is offered to everyone that attends the Legacy Workshop free of charge. This way, anyone that attends can create a basic will and Power of Attorney without cost. All that needs to be done is to input your personal data, print out the documents, sign the documents, and have them notarized. It only takes most folks 20 minutes after they have attended the workshop, read through the book, and completed the workbook. They then have a valid will and Power of Attorney to address their concerns and put their plan, rather than that of the state, in place.

Government statistics tell us that only about 30% of those who attend your church actually have any valid end of life documents. That means that 70% of those who attend your services each week are depending on the government to determine how their assets are distributed and who will raise their minor children. No reasonable person can think that is a good idea of a plan.

Don't you think it's time to at least offer your congregation the opportunity to change that??? There are still a few dates available for the fall of 2025 and many available after the first of the year. Review your church calendar and call Chuck Knox at 724-991-5303 today to discuss when this valuable workshop can be presented in your church and community.





LET'S JOIN HANDS TO MAKE AN IMPACT THROUGH LEGACY GIVING

Everyone wants to have a life with meaning. Part of that meaningful life is to live on in the memory of family and friends. Generous giving with eternal impact can indeed create a legacy for family and Kingdom ministry that gives added meaning to your life.

Would you prefer to leave your assets to the government or ministry?

We urge you to pray and ask the Lord for guidance about financially giving through your resources and estate to benefit the ministry of the Baptist Resource Network and its churches.

**INTERESTED?
CONTACT CHUCK KNOX, STEWARDSHIP COACH AT (724) 991-5303
OR STOP BY THE LEGACY GIVING EXHIBIT TODAY!**

#MULTIPLYPASJ

Over the last year we have been working through how we continue to create Antioch type of hubs through PA/SJ. For a frame of reference, we read about this church in Acts 11:19-30 and Acts 13:1-4.

This church is full of people who are ordinary men and women who said yes to Jesus and saw a multiplication movement. Later on, this church would become a diverse leadership team that would send out Paul and Barnabas and would serve as a home base for them.

We are on the cusp of seeing even more churches throughout our region taking their place in history of helping to see new disciples, leaders, ministries, and churches established. This is happening through creating regional teams, identifying those we can develop, and prayerfully creating Kingdom partnerships in order to further our Kingdom assignment.

As we move forward together I want to invite you to pray with us as we JOIN JESUS IN ADVANCING HIS KINGDOM. Here a couple of ways we can pray to that end:

1) *"This, then, is how you should pray: 'Our Father in heaven, hallowed be Your name, Your Kingdom come, Your will be done, on earth as it is in heaven'"* (Matthew 6:9-10).

2) *"Then He said to His disciples, 'The harvest is plentiful but the workers are few. Ask the Lord of the harvest, therefore, to send out workers into His harvest field'"* (Matthew 9:37-38).

3) *"My prayer is not for them alone. I pray also for those who will believe in Me through their message, that all of them may be one, Father, just as You are in Me and I am in You. May they also be in Us so that the world may believe that You have sent Me"* (John 17:20-21).

May we pray as Jesus prayed and believe He is still in the business of doing the impossible. As we see God move in Acts, we are a continuation of the story He is writing. We are meant to create hubs of multiplication and movement by the power of the Spirit.

"A HEALTHY MULTIPLYING CHURCH IS A CHURCH THAT REPRODUCES AND ULTIMATELY MULTIPLIES NEW DISCIPLES, LEADERS, MINISTRIES, AND CHURCHES THAT REINVEST WITHIN THE KINGDOM OF GOD."

By Joe Velarde

BRN Send Network PA/SJ
Recruitment Leader
Pastor, Riverbend
Community Church,
Bethlehem

NEXT GEN MINISTRY

Reaching The Next Generation Together through Collegiate Ministry

This has been a year of significant changes for the BRN Next Gen Collegiate Team! Those changes have allowed us to reimagine and redefine what the churches of the BRN do together to reach young adults in the PA/SJ region, especially those on our college and university campuses. There are three key words to describe what we do together. SUPPORT, ENGAGE, SEND.

We want to see our local BRN churches SUPPORTING their campus missionaries.

For the 2025-2026 academic year, the BRN has 4 full-time

self-funded campus missionaries and one campus missionary intern (*moving across the region from west to east*):

- *Scott Underhill* is our BRN campus missionary to Penn West University - Clarion.
- *Eric Reiber* is our BRN campus missionary to Penn State University - Main Campus.
- Rebekah Vaughn* is our (brand new) campus missionary intern to Penn State University - Main Campus.
- *Brady Rennix* is our BRN campus missionary to Montgomery County Community College, Delaware Valley University, Gwynedd Mercy University, and Chestnut Hill College.
- *Brian Musser* is our BRN

campus missionary to Drexel University.

These individuals have been sent as missionaries by the churches of the BRN to change the lives of college students with the Gospel of Jesus Christ. We have the opportunity to support our missionaries through prayer, participation, and finances. *Pay attention to the BRN UNITED weekly email or stop by the NEXT GEN Collegiate table for ways your church can pray, participate, and financially support your campus missionaries.*

During the 2024-2025 academic year we had the privilege of saying goodbye to several members of our team as they transitioned into a different phase of life:

CURRENT NEXT GEN MINISTRY NUMBERS

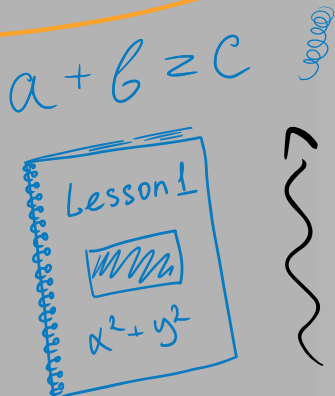

6 Ministries connected with BRN Next Gen Collegiate Ministry reported reaching over **10** distinct campuses

$4 + 2 = 6$
4 CAMPUS-BASED &
2 CHURCHED-BASED

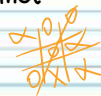

401 students regularly involved

* **1,785** students engaged (over 200 of those students were international students)

71 students actively sharing their faith with their peers on campus leading to ...

23 first-time professions of faith in Jesus Christ as Lord and Savior (22 students and 1 non-student)



149 students actively being disciplined and **48** student leaders discipling others

48 students participating in a short-term mission experience

85 students participating in Christian leadership development

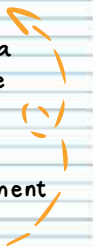

- *Jane Eliot*, campus missionary intern to Drexel University working primarily with international students, completed her two-year assignment.

- *Austin Burton*, campus missionary intern to Penn State University – Main Campus and Penn State University – Mont Alto Campus, transitioned to pursue other professional opportunities.

- *Kim Carson*, campus missionary to Penn West University – California Campus, transitioned to pursue full-time motherhood after 20 years of campus missionary work (6 in Florida and 14 with the BRN in PA/SJ).

- *Stanley Williams*, BRN Next Gen Collegiate Ministry Director, is now serving as the full-time pastor of Southside Baptist Church in Lumberton, N.J., after 20 years of campus ministry leadership first in Philadelphia and then for PA/SJ.



There are about 750,000 students on 284 campuses in the PA/SJ region. One hundred of those campuses do not have a known Gospel presence on its campus.

We want to see our local BRN Churches ENGAGING the nearby campuses.

There are about 750,000 students on 284 campuses in the PA/SJ region. One hundred of those campuses do not have a known Gospel presence on its campus.

The only way these students are reached will be through the combined efforts of churches in Pennsylvania and New Jersey. The churches of the BRN have a significant part to play in bringing the Gospel to the students on



our campuses, and many of our churches, like Big Woods Bible Church in Lock Haven and Steel City Church in Pittsburgh, are engaging students. We want to encourage, equip, and empower our local BRN churches to reach their nearby campuses, through resources, such as:

- *The Campus Across the Street and Campus Missionary Learning Communities:* We want to encourage our churches to ENGAGE the universities and colleges in their backyard as part of their mission field.

- *BRN evangelism grants, the AMPLIFY fall student retreat, and campus missionary interns:* We want to equip our churches who are already ENGAGING the campuses that are part of their mission field.

- *Self-funded campus missionaries in partnership with the BRN and embedded in specific local congregations:* We want to empower our churches to amplify their campus ENGAGEMENT.

We want to see our local BRN churches SENDING our best to reach the next generation.

We want to intentionally SEND our best:

- *graduating high school students* into colleges, universities, the armed forces, the workplace, and any other destination as missionaries with the Gospel of Jesus Christ.

- *young adults and college students* to serve in local, regional, and global short-term mission experiences.



- *graduating college students* into the workplace or the mission field as well-disciplined missionaries with the Gospel of Jesus Christ.

- *individuals from our BRN*

churches on mission to reach the next generation of young adults and college students—especially to the 100 campuses without a known Gospel ministry on campus.

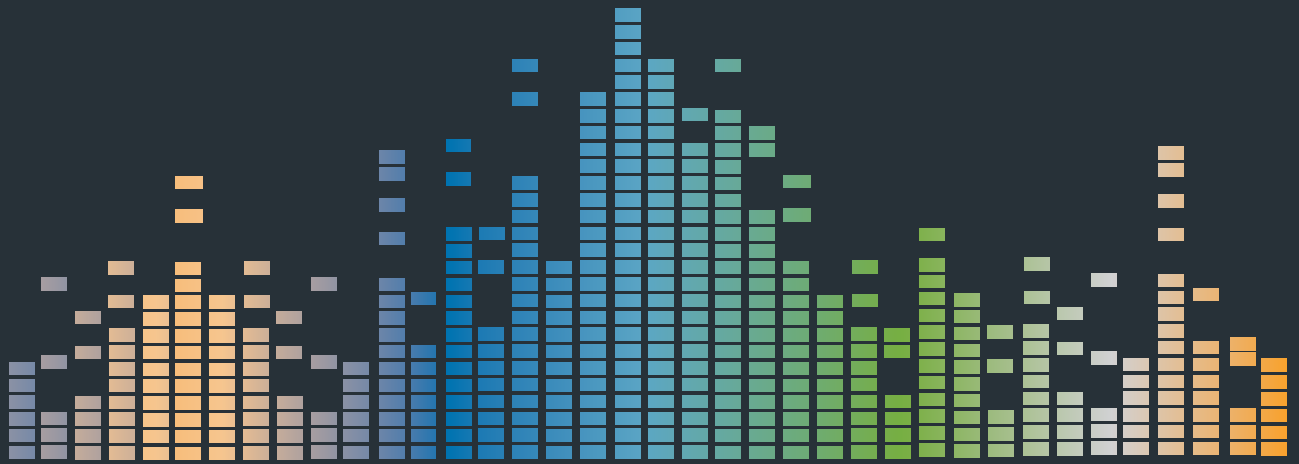

AMPLIFY

COLLEGIATE RETREAT

**REGISTRATION
NOW OPEN:**

**October 31, 6 p.m. to
November 2, noon**

**Camp Hebron,
Halifax, PA**

COST: \$125*

***ASK YOUR LOCAL CAMPUS MISSIONARY
IF CAMPUS DISCOUNTS ARE AVAILABLE**

Amplify Collegiate is a multi-day retreat for college students and young adults, ages 18-25.

Amplify God's voice in your life, amplify God's voice on your campus, and amplify God's voice throughout the world.

Attendees will experience worship, teaching, activities, and fellowship with fellow students from around the region. Throughout the course of the weekend, they will be challenged to understand and share the gospel in deeper and more practical ways.

College students and young adults connected with Baptist Resource Network churches and campus ministries are encouraged to attend.

LEARN MORE AT WWW.AMPLIFYPASJ.COM

WOVEN WOMEN

By Mary Landis

This has been a year of building deeper connections with the women we serve. Our goal is to support women leaders through their struggles and to celebrate as God moves and grows their ministries, while covering all these things in prayer. He clearly indicated that we were to focus on relationships first as we walk out His vision for Woven Women in 2025.

At Accelerate 2024, women were invited to choose one of several books on various topics as a gift to assist with their specific ministry needs. We also partnered with Dr. Brian King in leading the “Bold Prayer: From Words to Conversations” breakout session,

where attendees learned that confidence in Christ and a broken and contrite heart are the keys to bold prayer.

In early winter through spring 2025, we offered our Women’s Leadership Collective based on the book *Living Out of the Overflow* by Richard Blackaby. Three different scheduling options were available to accommodate our participants’ full calendars. Special thanks to everyone who participated, and to Cynthia King and Debbie Knowles, who each led a group.

At March’s Advance Evangelism Conference, our breakout speaker Sheila Alewine was unexpectedly unable to travel, so we jumped in to lead

our session entitled “Evangelism Close to Home.” Despite the last-minute change, the presentation was well received, and attendees walked away equipped with new ideas and inspiration to evangelize in their spheres of influence.

We are excited to announce that going forward and keeping in alignment with BRN’s event branding—*Accelerate, Amplify, Advance*—all Woven Women events will be entitled *Arise*. This new identifier will be introduced as we promote our first South Jersey event, which will be held at Fellowship CrossPoint Church on November 8. Please join us for this event.

We have continued to produce our monthly newsletter. This year we expanded it to include more content from the SBC community. We hope that this tool is useful to develop and disciple women’s ministry leaders, providing them with valuable resources and the unique, inspired perspective of writers from within our BRN churches. This newsletter belongs to the women who tirelessly serve in the trenches. This is a vehicle for their voices to be heard.

We would like to remind you that the BRN Lending Library remains available to anyone in the BRN, featuring many books and resources targeting a wide variety of audiences (not just women). It can be accessed via the BRN website.

This year we rolled out our bi-monthly Woven Women Volunteer Training to further



BRN Woven Women presents

ARISE

Breathe!

A TIME TO LET THE LORD
REFRESH YOU BEFORE
THE HOLIDAYS

November 8
9 a.m. to noon

**Fellowship
CrossPoint**
187 Crosswicks
Chesterfield Rd.
Chesterfield, NJ

\$15/person
incl breakfast

RSVP: BRNUNITED.ORG/WOMEN

BRN Woven Women
invites you!

LEARN MORE: brnunited.org/women



*Woven
Women*

**Sign up for the
Woven Women
newsletter:**



churches.

develop our team. These Zoom sessions enable us to grow as a unit, strengthen our leadership skills, and stay updated on ministry struggles and successes in all four BRN regions. Every session also includes a “Train the Trainer” segment, where each team member alternates leading the others in a relevant teaching. We continue to prayerfully seek additional volunteers to fill various roles.

Today we are participating in the “From Vision to Action: Creating a Missional Strategy” breakout session. We hope to see you there. We also invite you to visit the Woven Women table in the vendor area to say hello and receive a gift from us. We enjoy these encounters that provide opportunities to build on the relationships already forged

and begin new relationships with those we meet for the first time. We are a sisterhood in Christ, which provides a precious and unique bond.

In closing, we would like to express our appreciation for all the women in leadership across the BRN. We consider you one of the greatest gifts we receive through this ministry. And of course, we would be unable to fulfill God's mission without the gifts, contributions, and prayers of our extraordinary volunteer team. Heartfelt thanks go to our Woven Women regional volunteers: Crystal Brandon (Western), Cindy Fetty (Central), Kimberly Houston (Philadelphia), and Donna Hull (South Jersey). You are true assets to our team.

To all the women who have taken part in what we offer,

shared their ministries and ideas, served as guest writers for our newsletter, and simply offered encouragement, we cherish you. Above all else, we praise Jesus as we seek to follow His ministry model with each step we take.

PS - Once again, I want to offer a very special thanks to Debbie Knowles for her very significant contributions to Woven Women. Debbie, you always have your heart aligned with where God is leading us.

PPS - The Woven Women volunteer team would like to thank our director, Mary Landis, for her unwavering faith in the Lord's vision to grow and disciple the women who lead across the BRN region and for her constant encouragement and investment in each of us. We thank God for you, Mary.

SEND NETWORK PA/SJ



By John Cope,

Director,
Send Network PA/SJ
Founding Pastor,
Keystone Fellowship,
Montgomeryville, Pa.

Is Multiplication Optional?

In Matthew 28:19-20, Jesus emphatically declared that discipleship/multiplication is not optional. No BRN/SEND church would disagree with Christ's statement. Yet, why is this such a struggle for many churches?

We believe that every church can multiply. We also believe that when a church, regardless of size, sows the seeds of discipleship/multiplication, they will reap a harvest of Kingdom-minded leaders, and some of those God may call to plant churches.

We believe church planting is the most effective strategy for reaching the lost.

- Research indicates that new churches reach more lost people than older more established churches. It shows that a church plant three years old or younger will baptize 10 new believers for every 100 attendees. But a church that is 15 years old or older baptizes fewer than two new believers for every 100 attendees.
- Across 10 denominations, 3,500 churches close their doors every year, while only 4,000 churches are started each year.

Send Network PA/SJ, in partnership with BRN, desires to come alongside church leadership - providing training, leadership development, coaching, and resources in which to assist churches in the multiplication process.

For more information, contact John Cope, Director of Send Network PA/SJ, at jcope@namb.net.

Planting churches everywhere for everyone

STRENGTHENED PASTORAL LEADERSHIP. KINGDOM-BUILDING CHURCHES.

Discover how your ministry can excel as you apply the proven leadership models of successful church planters and revitalizers.



Scan the QR code or text **GREAT** to **888-123** to download your complimentary copy of *What Great Pastors Do*.



MISSION TRIPS



Send
Relief



Real needs meet lasting hope.

From U.S. cities to communities around the world, Send Relief trips connect you to hands-on opportunities to serve others and share the love of Jesus.



Explore opportunities near and far.
Text **TRIPS** to **888-123**



TOGETHER,

WE GO FURTHER

TO PURSUE THE LOST,

REACH MORE PEOPLE

WITH THE GOSPEL,

AND SEE MORE LIVES

CHANGED.



INTERNATIONAL
MISSION BOARD

imb.org

Helping each church advance the Great Commission together.

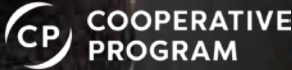

@scbaptist | scbaptist.org | #eachchurcheverylife

Inspiring the Church, Engaging Government, Impacting Culture.

Join us as we work together to see a world where
God is honored, religious freedom flourishes,
families thrive and life is cherished.



PENNSYLVANIA
Family Institute
Protect Life. Promote Family. Preserve Freedom.



CHURCH
AMBASSADOR
NETWORK

Pafamily.org



JAMES O. BOWER INSURANCE, INC.

5115. E. TRINDLE ROAD, MECHANICSBURG, PA 17050
(717) 763-5668 | (800) 326-7200
FAX (717) 763-5517

Insuring Churches, Schools and Camps in Pennsylvania

We offer insurance protection for churches, schools, and related ministries with comprehensive coverages, competitive rates, and quality service. Some of our unique coverages for schools include:

School Counseling Liability
Educational Preparation Liability
Broad Scope Media Liability

Religious Freedom Protection
Sexual Acts Liability
Security Operations Liability

STABILITY. TRUST. STEWARDSHIP.

Learn more:

800.326.7200
www.bowerins.com



An agency representing
**BROTHERHOOD
MUTUAL**

Church Accounting Giving You

THE SQUEEZE

Let WatersEdge help loosen your workload
so you can get back to ministry.



Get An Estimate:
WatersEdge.com/accounting
800-949-9988

WatersEdge

The North Carolina / Pennsylvania-South Jersey Partnership

BAPTISTS ON MISSION

What's This?:

An avenue through which North Carolina Baptist churches, associations, and individuals have opportunity to partner with Pennsylvania/South Jersey Baptist congregations, church plants, and ministries in fulfilling the task of reaching the lost for Christ.

What do Partnership Teams do?:

NC Partnership teams have served all around the world in many different ways:

Bible School
Backyard Bible Clubs
Community Surveys
Revival Teams
Youth and Children's Camps
Music ministry

New Construction
Renovation of existing facilities
Painting
Landscaping and cement work
Sports clinics and camps
Leadership Training ...And More!

What can a Partnership team do for me and my church?

The purpose of a NC Partnership team is to partner with you in reaching your community for Christ. This could include a direct ministry such as a Backyard Bible Club, sports camp, evangelism, and other outreach activities – OR - one that better equips your church for ministry – such as leadership training or facility construction or renovation.

How much will having a Partnership team cost?

NC Partnership teams pay their own way to the field. They are also prepared to pay their own housing, transportation, and meals *if necessary*. If it's possible for them to stay in your church facility and/or for your church to provide one meal a day for them – that helps greatly, but is not required. Also, evangelistic outreach teams are willing to bring ministry supplies if needed. Construction and renovation-type teams usually expect materials to be provided by the requesting church or organization – although on occasion, they may be willing to contribute toward materials if needed.

How do I go about requesting a team from North Carolina?

Pray about how you might use a volunteer missionary team to assist you in fulfilling your ministry. Fill out one (or more!) of the [electronic request forms](#). It will be automatically sent to Mark Abernathy, Baptists on Mission (BOM). We will be glad to receive requests throughout the year, but most of our churches begin their missions planning 8-10 months in advance, so please submit the request as soon as possible. If you need an electronic form sent to you, please email Mark Abernathy at mabernathy@ncbaptist.org

What happens then?

Baptists on Mission will work to promote your project among our churches here in North Carolina (and beyond via our website!) and help find a team to fill it. While we cannot guarantee a team to fill your request, we will promote it throughout the year in a variety of ways. When a team shows interest, the team leader will be put in direct contact with you. If you both feel it is a good fit, you both will set the dates of service and work out all the necessary details.

If you have any questions about the North Carolina/Pennsylvania-South Jersey Partnership, please feel free to contact:

Mark Abernathy, Baptists on Mission (919-459-5607; mabernathy@ncbaptist.org) or
Dewey and Kathie Aiken, NC/PA-SJ On-Site Coordinators (828-553-7694; dewey_kate@hotmail.com)

Baptists on Mission is an auxiliary of the Baptist State Convention of North Carolina

CLUB ENCOURAGE GIFTS

Custom Spiritually Uplifting Gifts
to Enhance Your Ministry



Get Well



Celebration

"What you offer has
been a great tool for us
to care for others,
Julianne.
I plan on continuing
this partnership
into the future!"

Pastor Adam



Seasonal



Sympathy

info@ClubEncourage.com
ClubEncourage.com

STAY CONNECTED!

BRN UNITED WEEKLY NEWSLETTER

Subscribe to the weekly e-newsletter of the Baptist Resource Network of Pennsylvania/South Jersey, which features news, events and resources of interest to Southern Baptists in our region. brnunited.org/news

WOVEN WOMEN MONTHLY NEWSLETTER

Sign up to receive a monthly update about women's ministry opportunities as well as timely content relevant to women. brnunited.org/women

#RENEWPASJ MONTHLY NEWSLETTER

Sign up to receive this monthly newsletter, organized by David Ludwig, BRN director of discipleship and leadership development, with tips for intentional discipleship, leadership development, and church revitalization and strengthening. brnunited.org/renew

BRN HELP DESK

Have questions? Need a resource? Feel free to reach out to the Baptist Resource Network's Help Desk. Email helpdesk@brnunited.org or call or text (717) 652-5856.

At GuideStone, our vision is that every servant
of Christ **finishes well**.

We offer comprehensive solutions intentionally designed to provide support, guidance
and protection every step of the way.



Retirement Plans



Health Plans and Other Coverages



Faith-based Investing



Property and Casualty Insurance



Mission:Dignity®



For more information,
visit GuideStone.org

GuideStone®



S A V E T H E D A T E

..... **WMU**

**ANNUAL MEETING
SATURDAY,
APRIL 25, 2026**

PA.SJWMU@GMAIL.COM



**AROUND THE CORNER
MINISTRIES**

**P.O. Box 242
Etowah, NC 28729
828.551.0281**

**aroundthecornerministries.org
todd@aroundthecornerministries.org**



*Equipping followers of Jesus to engage their neighborhoods
and communities with the gospel.*

Help your church navigate sexual sin

Harvest USA has helped individuals, families, and churches impacted by sexual sin for over 40 years.

We offer biblical resources like books, articles, curriculum, and video series on topics like...

- Pornography
- Spousal Unfaithfulness
- Same Sex Attraction
- Transgenderism
- Parenting
- Marriage

... and more!



Visit HarvestUSA.org to start equipping your church today.



SUPPORT YOUR CHURCH THROUGH TIMBER!

WAYS TO GIVE

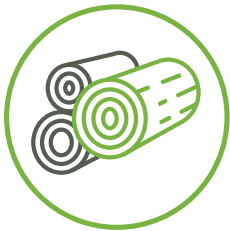

CUTTING

Give a cutting or thinning

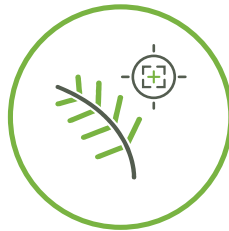

LEASE

Give pine straw or hunting income



PROPERTY

Give all or part of your property

Learn More or Get Started Today!

www.christiantimber.org



**CHRISTIAN
TIMBER
RESERVE**

A BAPTIST RESOURCE NETWORK GLOSSARY OF TERMS

ACCELERATE CONFERENCE: The Baptist Resource Network's annual gathering, held each autumn, provides inspiration, training, and encouragement to churches. The conference also hosts a short business meeting to highlight accomplishments and vision.

ADVANCE CONFERENCE: The Baptist Resource Network's annual evangelism conference.

AMPLIFY CONFERENCE: This annual conference focuses on evangelizing, engaging, and equipping college students.

ANNIE ARMSTRONG EASTER OFFERING (AAEO): An offering held around Easter to support the field work of the North American Mission Board.

ANNUAL CHURCH PROFILE (ACP): Also known as the annual letter, this is the annual report sent from the local churches to the state convention.

BAPTIST FAITH & MESSAGE (BF&M): The list of beliefs held by Southern Baptists.

COOPERATIVE PROGRAM (CP): Southern Baptists' unified plan of giving through which cooperating Southern Baptist churches give a percentage of their undesignated receipts to support cooperative missions and ministries in the BRN and the SBC.

ETHICS & RELIGIOUS LIBERTY COMMISSION (ERLC): A national entity who addresses specific moral issues in broader cultural conversations.

GREAT COMMISSION BAPTISTS: Great Commission Baptists, affiliated with the Southern Baptist Convention, seek to follow God's command to make disciples of all nations.

GUIDESTONE: A SBC entity who provides health insurance, life insurance, retirement accounts, and taxation information as well as wellbeing resources for churches.

INTERNATIONAL MISSION BOARD (IMB): The missionary sending agency of the SBC that deploys outside of North America.

LEGACYPASJ: A fund began in 2021 with the assistance of Ministry Trust (theministryfund.org) to support the Baptist Resource Network's long-term viability.

LIFEWAY CHRISTIAN RESOURCES: The publishing house of the SBC, Lifeway is one of the world's largest providers of Christian resources.

LOTTIE MOON CHRISTMAS OFFERING (LMCO): An offering held around Christmas to support the field work of the International Mission Board.

LOVEPASJ IMPACT FUNDS: One hundred percent of this offering stays in Pennsylvania/South Jersey and supports ministry in these areas: Church Advancement, Church Starting and Missions Sending, Compassion Ministry/Disaster Relief, Next Gen Mobilization, and Pastoral Care and Wellness.

NORTH AMERICAN MISSION BOARD (NAMB): The missionary sending agency of the SBC that deploys in North America.

WOMAN'S MISSIONARY UNION (WMU): A missions education, prayer support, and involvement organization that also promotes the Annie Armstrong and Lottie Moon offerings.



120 S. Wingate St.
Wake Forest, NC 27587
(919) 761-2100
sebts.edu

Every Classroom a Great
Commission Classroom

UPCOMING OPPORTUNITIES:

- ▶ **ACCELERATE CONFERENCE**, October 7, 2025
- ▶ **ADVANCE CONFERENCE**, March 16, 2026 (Calvary Baptist Church, State College, Pa.)
- ▶ **AMPLIFY COLLEGIATE RETREAT**, October 31-November 2, 2025 (Camp Hebron, Halifax, Pa.)
- ▶ **CAMPUS MISSIONARY RETREAT**, June 5-6, 2026 (Location TBD)
- ▶ **COMPASSION MINISTRY TRAININGS**, ongoing
- ▶ **COOPERATIVE PROGRAM MONTH**, October 2025
- ▶ **DISASTER RELIEF ADVANCED TRAININGS**, March 27-28, 2026 (Bucks County Community Church, Langhorne, Pa.) and April 10-11, 2026, (Location TBD in the Western Region)
- ▶ **DISCIPLESHIP TRAINING**, January 15 (BRN Hub)
- ▶ **D-LIFE BOOTCAMPS**, ongoing
- ▶ **FALL CAMPUS MISSIONARY LEARNING COMMUNITY (CMLC)**, September 25-26, 2026 (Location TBD)
- ▶ **FIRST STEPS GATHERINGS**, November 11, 2025, and April 18, 2026 (BRN Hub)
- ▶ **GIVING TUESDAY**, December 2, 2025
- ▶ **LEGACY WORKSHOPS**, ongoing
- ▶ **LOVEPASJ IMPACT FUNDS WEEK OF PRAYER AND OFFERING**, August 16-23 or September 13-20
- ▶ **NATIONAL COLLEGIATE SUMMIT**, May 6-8, 2026, Memphis, Tenn. (FBC, Collierville)
- ▶ **NEXT LEVEL CONVERSATIONS**, ongoing
- ▶ **PULPIT SUPPLY**, ongoing
- ▶ **SEND NETWORK ONE DAY EVENTS WITH MAC LAKE**, October 24-25 (Philadelphia) and November 19 (Pittsburgh)
- ▶ **SOUTHERN BAPTIST CONVENTION ANNUAL MEETING AND PASTOR'S CONFERENCE**, June 7-10, 2026 (Orlando, Fla.)
- ▶ **SERVE LEHIGH VALLEY**, June 26-27, 2026 (Various locations)
- ▶ **VBS TRAINING**, April 25, 2026 (BRN Hub)
- ▶ **WARREN-PITTSBURGH MISSION HOUSE OPEN HOUSE**, November 15
- ▶ **WEEK OF PRAYER FOR NORTH AMERICAN MISSIONS AND ANNIE ARMSTRONG EASTER OFFERING**, March 1-8, 2026
- ▶ **WEEK OF PRAYER FOR INTERNATIONAL MISSIONARIES AND LOTTIE MOON CHRISTMAS OFFERING**, November 30-December 7, 2025
- ▶ **WINTER CAMPUS MISSIONARY LEARNING COMMUNITY (CMLC)**, January 30-31, 2026
- ▶ **WOVEN WOMEN ARISE-BREATHE GATHERING**, November 8 (Fellowship CrossPoint Church, Chesterfield, N.J.)
- ▶ **WOVEN WOMEN LEADERSHIP COLLECTIVES**, February 17-May 20

STAY TUNED TO BRNUNITED.ORG/EVENTS FOR THE EMERGING DETAILS.

Thank you

to the following for
making today possible:

Best Printing USA, Norwalk, CT
BRN Executive Board
BRN Team Members
Conference Attendees
Conference Presenters
Conference Volunteers
RCTV Productions
Sheraton Harrisburg-Hershey Hotel
Sponsors & Vendors
Stray Production Services

and finally, our BRN churches and partners!
*Your generous support of the Cooperative Program
makes this ministry possible and fuels evangelism
and outreach in our local churches and all over the
world! Thank you!*

Want to have **lasting** impact?

Join together to fund the opportunity to love our neighbors across PA/SJ. Inspired by Ed and Mary Price, early church-planting pioneers in PA/SJ, the Baptist Resource Network's #LovePASJ Impact Funds give you the opportunity to make a difference according to your passions. How can you make a difference today?

- Church Advancement
- Compassion Ministry/Disaster Relief
- Next Generation Mobilization
- Pastoral Care and Wellness
- Church Starting
- and Missions Sending *and more!*



Baptist Resource Network presents

ADVANCE

EVANGELISM CONFERENCE



WILLIAM 'DUCE' BRANCH

Executive Director of Equip Theological Training, Blueprint Church, Atlanta, Ga.; Adjunct Professor, Southeastern Baptist Theological Seminary



DAVE EARLEY

Author, Speaker at Dave Earley Ministries; Former assistant professor, Liberty University

**MARCH
16, 2026**

**CALVARY CHURCH
STATE COLLEGE**

ADVANCEPASJ.COM